

## **Volume III**

There were no changes to Volume III aside from the inadvertent omission of Section H, described below.

### **Section H**

Section H: Record Set PEPD Design Submission – Sound Barrier Plans was inadvertently omitted from Volume III during publication of the Draft Supplemental EIR/EIS. These plans are included here. No changes have been made to the drawings, and the inclusion of these plans does not change the footprint or findings of the F-B LGA project.

**This page intentionally left blank**

California High-Speed Rail Authority

# Fresno to Bakersfield Section

Locally Generated Alternative  
RECORD SET PEPD DESIGN SUBMISSION

Sound Barrier Plans

August 2018

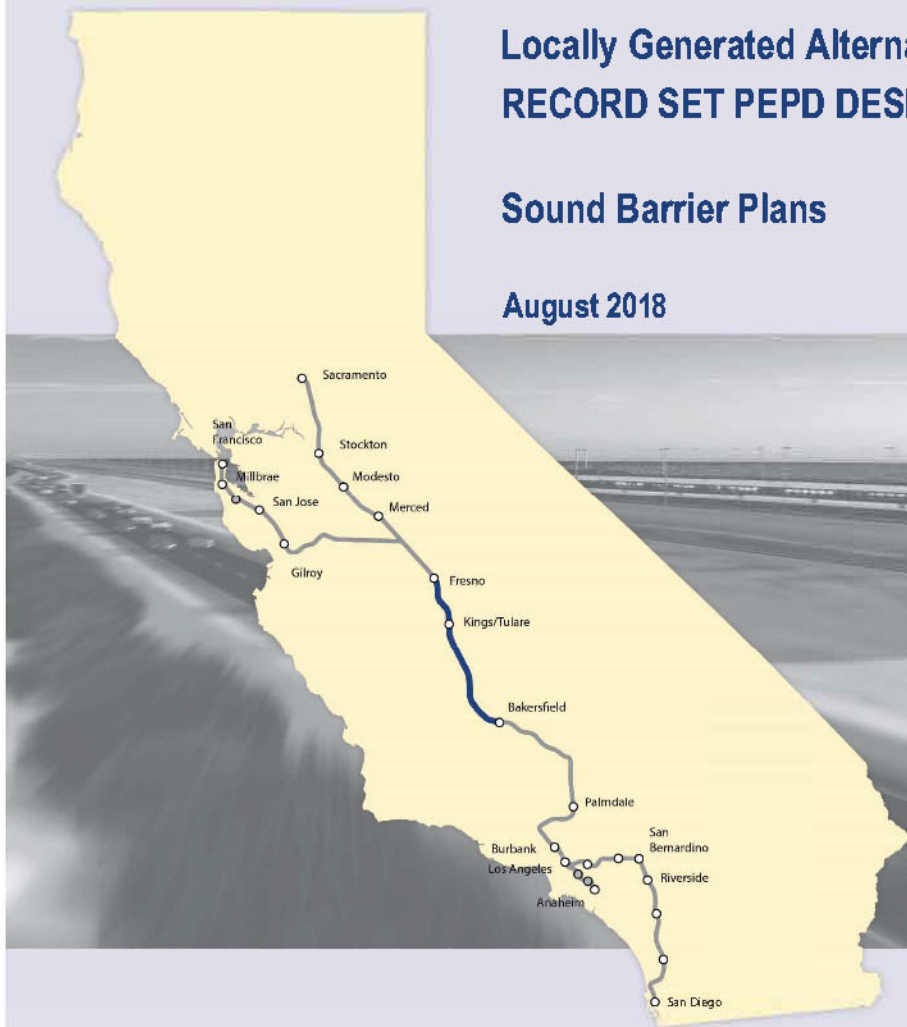

## Index of Drawings

Drawing No.	Included?	Drawing Description
		Track Guideway
TT-B0001	Yes	Index of Drawings
TT-B0002	No	General - General Notes
TT-B0003	No	General - Abbreviations and Symbols Sheet 1
TT-B0004	No	General - Abbreviations and Symbols Sheet 2
TT-B0005	Yes	Track Guideway - Key Map Sheet 1
TT-B0006	Yes	Track Guideway - Key Map Sheet 2
TT-B0007	No	Track Guideway - Horizontal Alignment Data Table
TT-B0008	No	Track Guideway - Typical Sections Sheet 1
TT-B0009	No	Track Guideway - Typical Sections Sheet 2
TT-B0010	No	Track Guideway - Typical Sections Sheet 3
TT-B0011	No	Track Guideway - Typical Sections Sheet 4
TT-B0012	No	Track Guideway - Typical Sections Sheet 5
TT-B0013	No	Track Guideway - Typical Sections Sheet 6
TT-B0014	No	Track Guideway - Typical Sections Sheet 7
TT-B0015	No	Track Guideway - Typical Sections Sheet 8
TT-B0016	No	Track Guideway - Typical Sections Sheet 9
TT-B0017	No	Track Guideway - Typical Sections Sheet 10
TT-B0018	No	Track Guideway - Typical Sections Sheet 11
TT-B0019	No	Track Guideway - Typical Sections Sheet 12
TT-B0020	No	Track Guideway - Typical Sections Sheet 13
TT-B0021	No	Track Guideway - Typical Sections Sheet 14
TT-B0022	No	Track Guideway - Typical Sections Sheet 15
TT-D1001	No	Track Guideway - STA 5880+00 to 5890+00 - Plan and Profile
TT-D1002	Yes	Track Guideway - STA 5890+00 to 5918+00 - Plan and Profile
TT-D1003	Yes	Track Guideway - STA 5918+00 to 5946+00 - Plan and Profile
TT-D1004	Yes	Track Guideway - STA 5946+00 to 5974+00 - Plan and Profile
TT-D1005	Yes	Track Guideway - STA 5974+00 to 6002+00 - Plan and Profile
TT-D1006	Yes	Track Guideway - STA 6002+00 to 6030+00 - Plan and Profile
TT-D1007	No	Track Guideway - STA 6030+00 to 6058+00 - Plan and Profile
TT-D1008	No	Track Guideway - STA 6058+00 to 6086+00 - Plan and Profile
TT-D1009	No	Track Guideway - STA 6086+00 to 6114+00 - Plan and Profile
TT-D1010	No	Track Guideway - STA 6114+00 to 6142+00 - Plan and Profile
TT-D1011	No	Track Guideway - STA 6142+00 to 6170+00 - Plan and Profile
TT-D1012	No	Track Guideway - STA 6170+00 to 6198+00 - Plan and Profile
TT-D1013	No	Track Guideway - STA 6198+00 to 6226+00 - Plan and Profile
TT-D1014	No	Track Guideway - STA 6226+00 to 6254+00 - Plan and Profile
TT-D1015	No	Track Guideway - STA 6254+00 to 6282+00 - Plan and Profile
TT-D1016	No	Track Guideway - STA 6282+00 to 6310+00 - Plan and Profile
TT-D1017	No	Track Guideway - STA 6310+00 to 6338+00 - Plan and Profile
TT-D1018	No	Track Guideway - STA 6338+00 to 6366+00 - Plan and Profile
TT-D1019	No	Track Guideway - STA 6366+00 to 6394+00 - Plan and Profile
TT-D1020	No	Track Guideway - STA 6394+00 to 6422+00 - Plan and Profile
TT-D1021	No	Track Guideway - STA 6422+00 to 6450+00 - Plan and Profile
TT-D1022	No	Track Guideway - STA 6450+00 to 6478+00 - Plan and Profile
TT-D1023	No	Track Guideway - STA 6478+00 to 6506+00 - Plan and Profile
TT-D1024	No	Track Guideway - STA 6506+00 to 6534+00 - Plan and Profile
TT-D1025	No	Track Guideway - STA 6534+00 to 6562+00 - Plan and Profile
TT-D1026	No	Track Guideway - STA 6562+00 to 6590+00 - Plan and Profile
TT-D1027	No	Track Guideway - STA 6590+00 to 6618+00 - Plan and Profile
TT-D1028	Yes	Track Guideway - STA 6818+00 to 6646+00 - Plan and Profile
TT-D1029	Yes	Track Guideway - STA 6646+00 to 6674+00 - Plan and Profile
TT-D1030	Yes	Track Guideway - STA 6674+00 to 6702+00 - Plan and Profile
TT-D1031	Yes	Track Guideway - STA 6702+00 to 6730+00 - Plan and Profile
TT-D1032	Yes	Track Guideway - STA 6730+00 to 6758+00 - Plan and Profile
TT-D1033	Yes	Track Guideway - STA 6758+00 to 6786+00 - Plan and Profile
TT-D1034	Yes	Track Guideway - STA 6786+00 to 6814+00 - Plan and Profile
TT-D1035	Yes	Track Guideway - STA 6814+00 to 6828+00 - Plan and Profile

Drawing No.	Included?	Drawing Description
		Track Guideway
TT-D1036	Yes	Track Guideway - STA 6828+00 to 6842+00 - Plan and Profile
TT-D1037	Yes	Track Guideway - STA 6842+00 to 6856+00 - Plan and Profile
TT-D1038	Yes	Track Guideway - STA 6856+00 to 6870+00 - Plan and Profile
TT-D1039	Yes	Track Guideway - STA 6870+00 to 6884+00 - Plan and Profile
TT-D1040	Yes	Track Guideway - STA 6884+00 to 6912+00 - Plan and Profile
TT-D1041	Yes	Track Guideway - STA 6912+00 to 6940+00 - Plan and Profile
TT-D1042	Yes	Track Guideway - STA 6940+00 to 6968+00 - Plan and Profile
TT-D1043	Yes	Track Guideway - STA 6968+00 to 6996+00 - Plan and Profile
TT-D1044	Yes	Track Guideway - STA 6996+00 to 7024+00 - Plan and Profile
TT-D1045	Yes	Track Guideway - STA 7024+00 to 7052+00 - Plan and Profile
TT-D1046	Yes	Track Guideway - STA 7052+00 to 7080+00 - Plan and Profile
TT-D1047	Yes	Track Guideway - STA 7080+00 to 7101+00 - Plan and Profile
TT-D1048	No	Track Guideway - Station Tracks - STA 0+00 to 26+00 - Plan and Profile
TT-D1049	No	Track Guideway - Station Tracks - STA 26+00 to 48+93 - Plan and Profile
TT-D1050	No	Track Guideway - Station NB Storage Track - Plan and Profile
TT-D1051	No	Track Guideway - Station SB Storage Track - Plan and Profile
TT-D1052	No	BNSF Plan - STA 1002+00 to STA 1033+00
TT-D1053	No	BNSF Plan - STA 1033+00 to STA 1063+00
TT-D1054	No	BNSF Plan - STA 1063+00 to STA 1094+00
TT-D1055	No	BNSF Plan - STA 1094+00 to STA 1129+89
TT-D1056	No	BNSF TOR Profile - STA 865+00 to STA 916+00 - Sheet 1
TT-D1057	No	BNSF TOR Profile - STA 916+00 to STA 972+00 - Sheet 2
TT-D1058	No	BNSF TOR Profile - STA 972+00 to STA 1028+00 - Sheet 3
TT-D1059	No	BNSF TOR Profile - STA 1028+00 to STA 1084+00 - Sheet 4
TT-D1060	No	BNSF TOR Profile - STA 1084+00 to STA 1122+00 - Sheet 5



Projects\101206\N.BF55.00\_CADD\Sheet Files\Sound Barriers\BFAA-TT-B0006.dgn #PENTBLS# #PENTBLS# #PENTBLS# 12/21/2016 2:59:46 PM #PENTBLS#

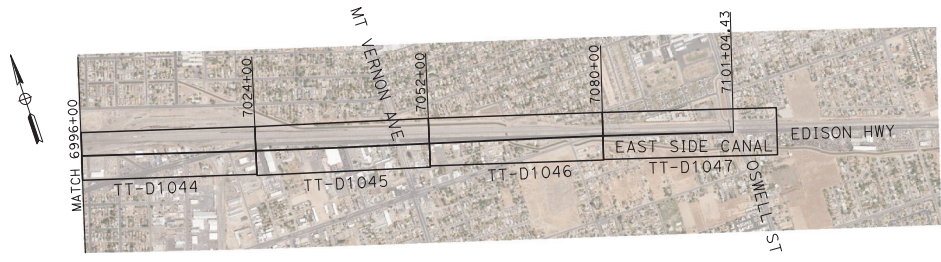
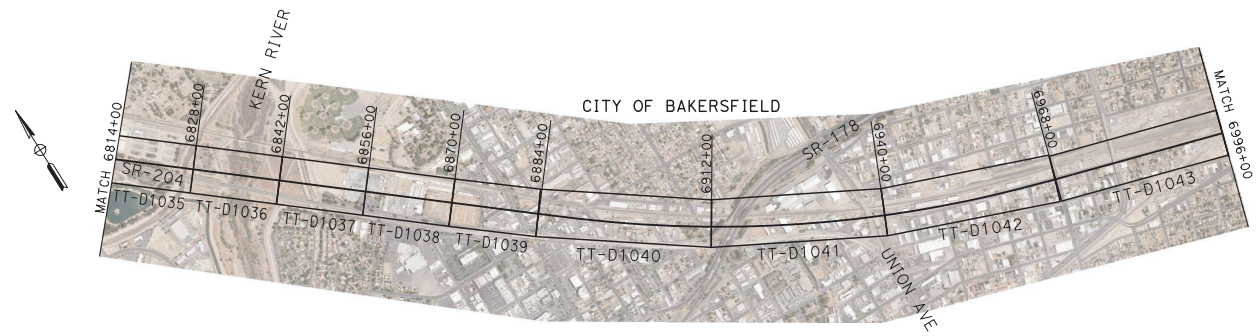
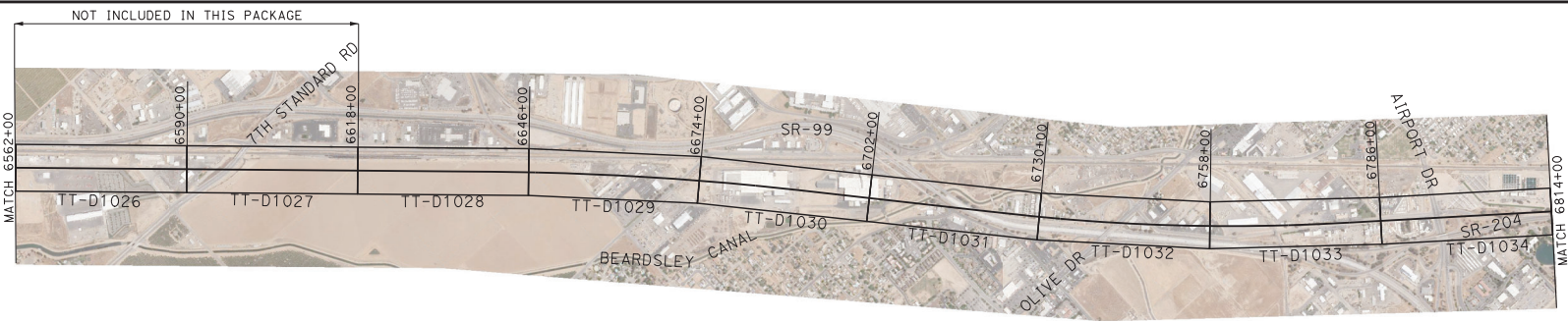

DRAWING NUMBERS ARE CONSISTENT WITH THE 15% RECORD SET PACKAGE. ONLY RELEVANT DRAWINGS ARE INCLUDED IN THIS SOUND BARRIER PACKAGE.

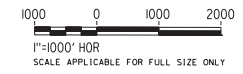

REV	DATE	BY	CHK	APP	DESCRIPTION

DESIGNED BY  
J. TREJO  
DRAWN BY  
N. OLINO  
CHECKED BY  
E. WINTERS  
IN CHARGE  
P. PIENTON  
DATE  
10/28/2016

**RECORD SET  
PEPD DESIGN  
SUBMISSION**

**TYLINT** INTERNATIONAL



**CALIFORNIA HIGH-SPEED RAIL PROJECT**  
**FRESNO TO BAKERSFIELD**  
LOCALLY GENERATED ALTERNATIVE  
TRACK GUIDEWAY  
KEY MAP SHEET 2

CONTRACT NO.  
HSR13-44  
DRAWING NO.  
TT-B0006  
SCALE  
AS SHOWN  
SHEET NO.

Projects\701206\N.BF55.00\_CADD\Sheet Files\Sound Barriers\BF55A-TT-D1002.dgn  
 #P:LTRVRS#  
 #P:ENTBLS#  
 12/21/2016 2:59:55 PM

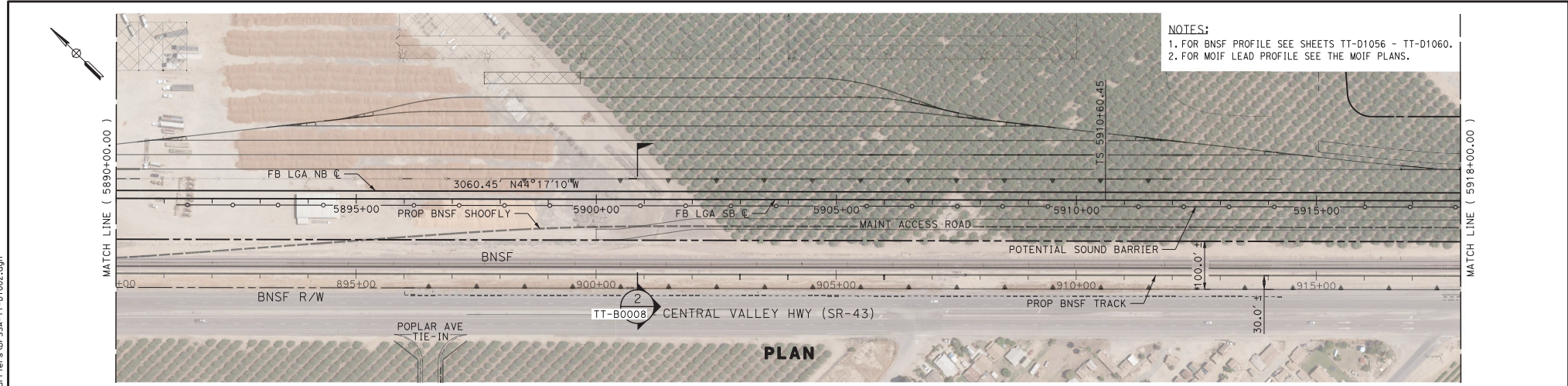

NOTES:  
 1. FOR BNSF PROFILE SEE SHEETS TT-D1056 - TT-D1060.  
 2. FOR MOIF LEAD PROFILE SEE THE MOIF PLANS.

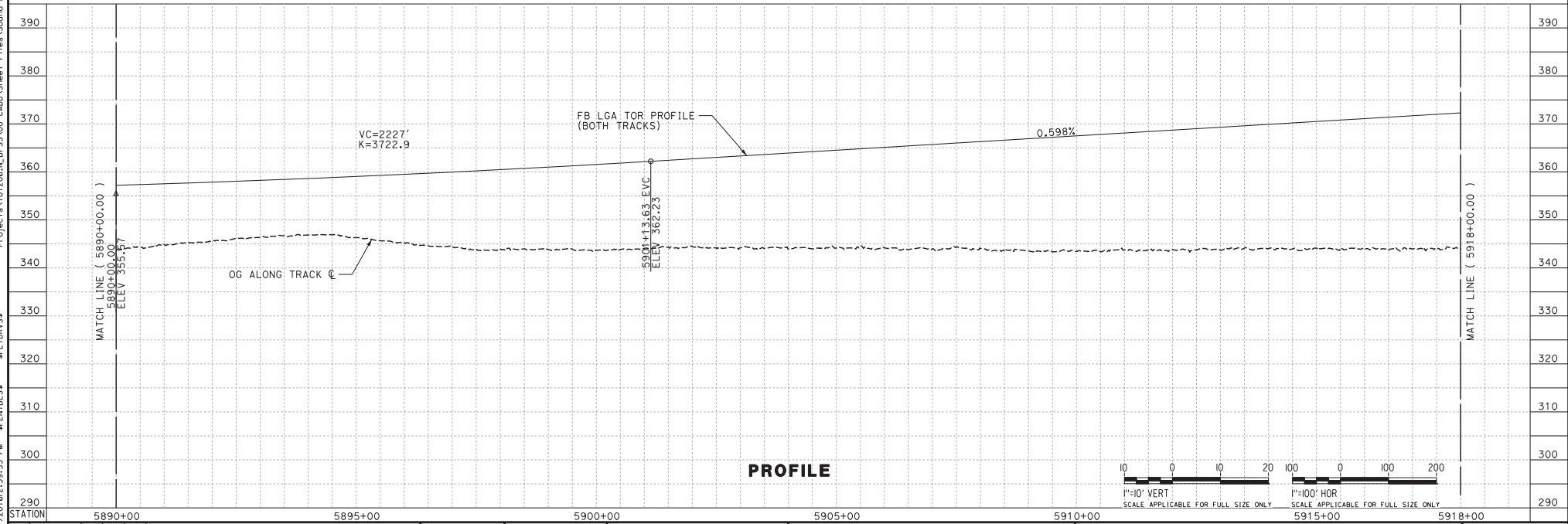

**PROFILE**

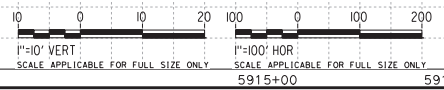

DESIGNED BY J. TREJO	<b>RECORD SET          PEDD DESIGN          SUBMISSION</b>
DRAWN BY T. WILKINSON	
CHECKED BY E. WINTERS	
IN CHARGE P. PIENTON	
DATE 10/28/2016	

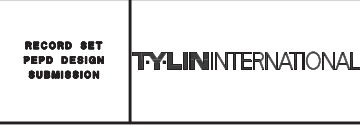

**CALIFORNIA HIGH-SPEED RAIL PROJECT**  
**FRESNO TO BAKERSFIELD**  
 LOCALLY GENERATED ALTERNATIVE  
 TRACK GUIDEWAY  
 STA 5890+00 TO 5918+00  
 PROPOSED SOUND BARRIER

CONTRACT NO. HSR13-44
DRAWING NO. TT-D1002
SCALE AS SHOWN
SHEET NO.

REV	DATE	BY	CHK	APP	DESCRIPTION

Projects\701206.N.BF55.00\_CADD\Sheet Files\Sound Barriers\BFA-TT-D1003.dgn  
 #P:LTRVCS#  
 #P:ENTBLS#  
 12/21/2016 2:59:52 PM

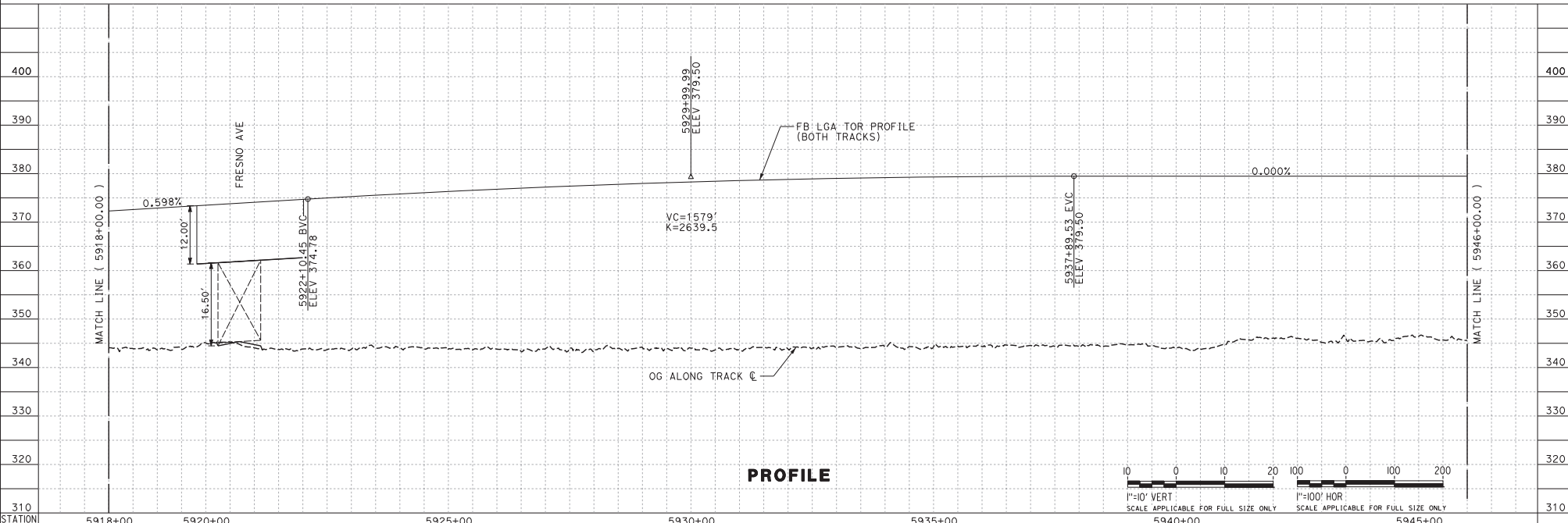
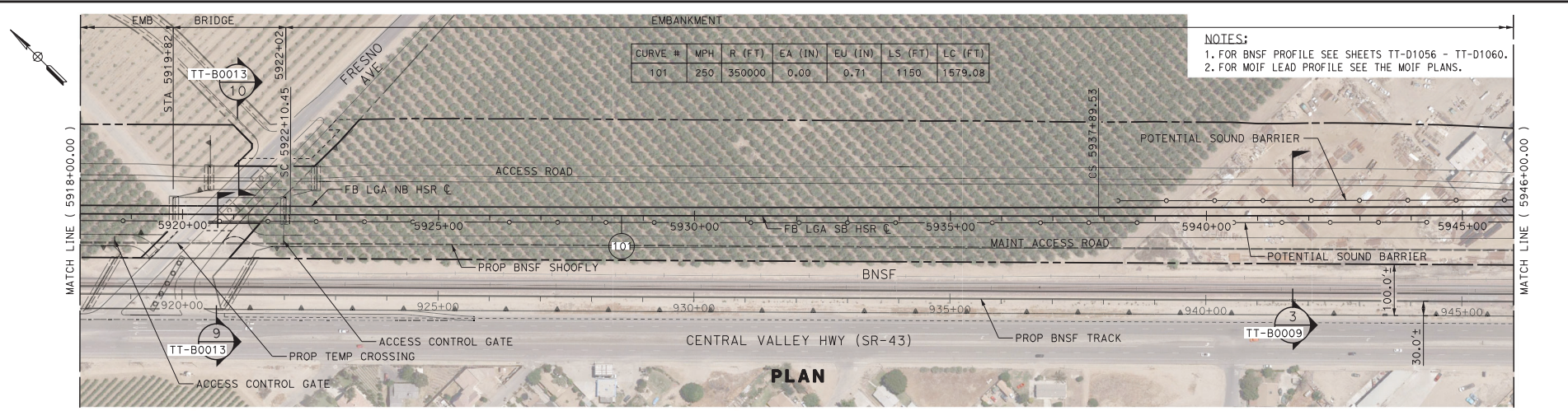

REV	DATE	BY	CHK	APP	DESCRIPTION

DESIGNED BY  
**J. TREJO**

DRAWN BY  
**T. WILKINSON**

CHECKED BY  
**E. WINTERS**

IN CHARGE  
**P. PIENTON**

DATE  
**10/28/2016**

**RECORD SET  
 PEDD DESIGN  
 SUBMISSION**

**TYLINTINTERNATIONAL**



**CALIFORNIA HIGH-SPEED RAIL PROJECT**  
**FRESNO TO BAKERSFIELD**  
 LOCALLY GENERATED ALTERNATIVE  
 TRACK GUIDEWAY  
 STA 5918+00 TO 5946+00  
 PROPOSED SOUND BARRIER

CONTRACT NO.  
**HSR13-44**

DRAWING NO.  
**TT-D1003**

SCALE  
**AS SHOWN**

SHEET NO.



Projects\701206\N.BF55\00\_CADD\Sheet Files\Sound Barriers\BFA-TT-D1004.dgn

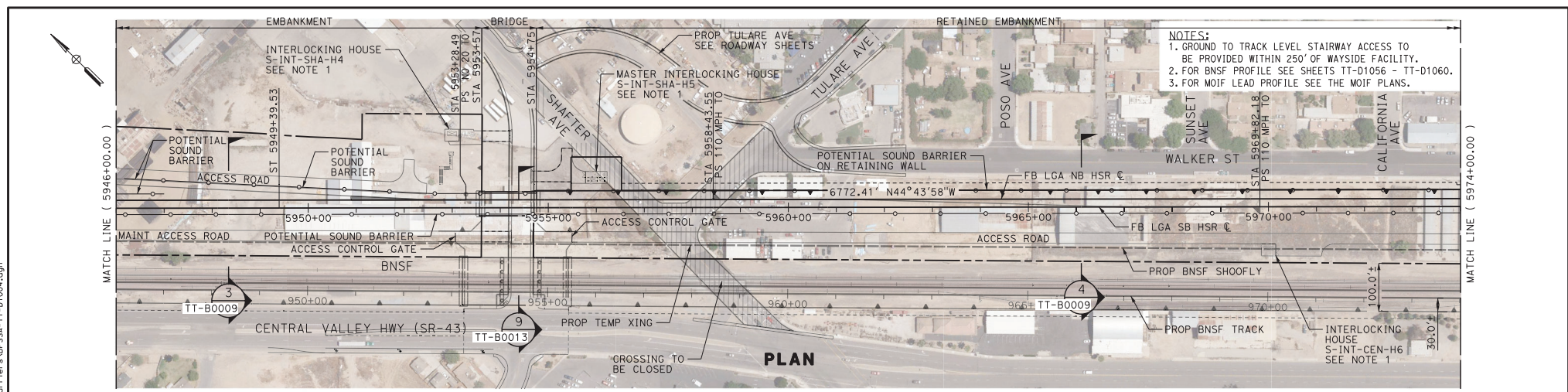

- NOTES:**
1. GROUND TO TRACK LEVEL STAIRWAY ACCESS TO BE PROVIDED WITHIN 250' OF WAYSIDE FACILITY.
  2. FOR BNSF PROFILE SEE SHEETS TT-D1056 - TT-D1060.
  3. FOR MOIF LEAD PROFILE SEE THE MOIF PLANS.

**PLAN**

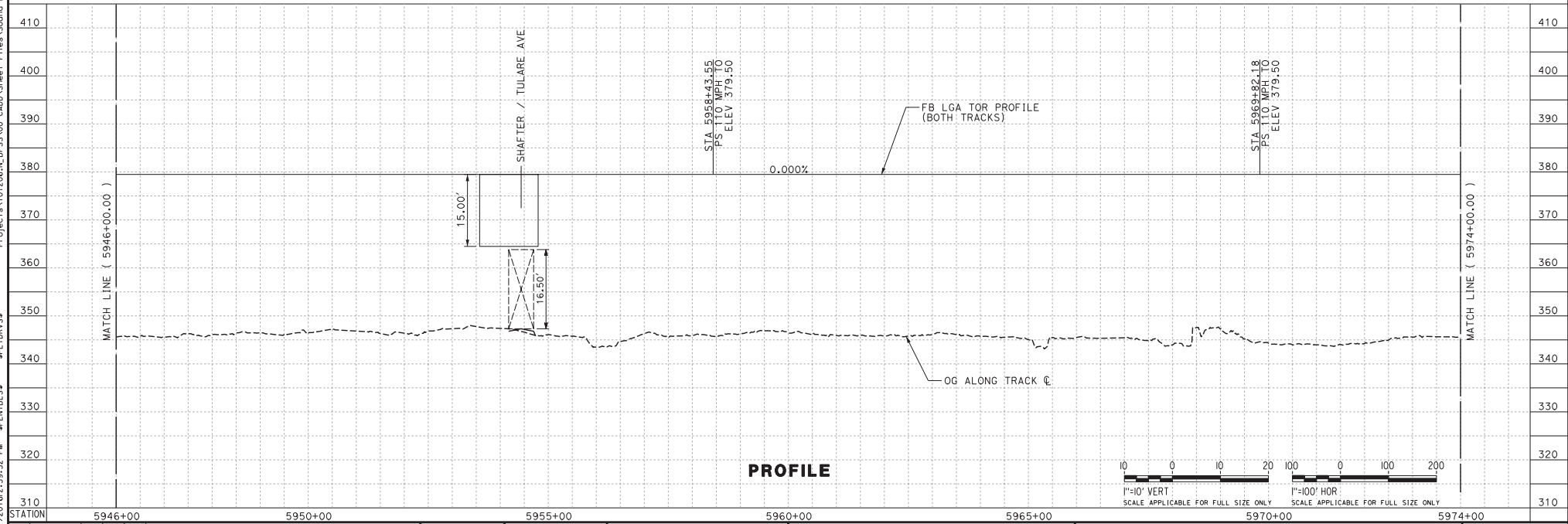

**PROFILE**

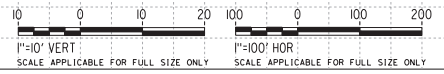

REV	DATE	BY	CHK	APP	DESCRIPTION

DESIGNED BY  
**J. TREJO**  
DRAWN BY  
**T. WILKINSON**  
CHECKED BY  
**E. WINTERS**  
IN CHARGE  
**P. PIENTON**  
DATE  
**10/28/2016**

**RECORD SET  
PEPD DESIGN  
SUBMISSION**



**CALIFORNIA HIGH-SPEED RAIL PROJECT**  
**FRESNO TO BAKERSFIELD**  
LOCALLY GENERATED ALTERNATIVE  
TRACK GUIDEWAY  
STA 5946+00 TO 5974+00  
PROPOSED SOUND BARRIER

CONTRACT NO.  
HSR13-44  
DRAWING NO.  
TT-D1004  
SCALE  
AS SHOWN  
SHEET NO.



Projects\701206\N.BF55.00\_CADD\Sheet Files\Sound Barriers\BFS-A-TT-D1006.dgn  
 #P:LDIVS#  
 #P:ENTBLS#  
 12/21/2016 10:00:33 PM

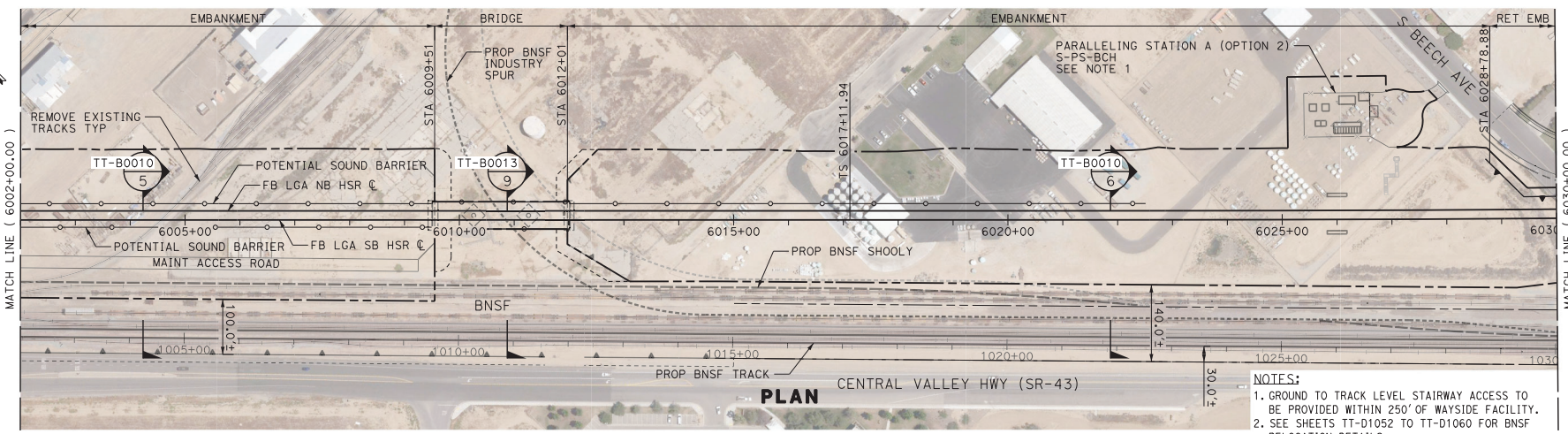

**NOTES:**  
 1. GROUND TO TRACK LEVEL STAIRWAY ACCESS TO BE PROVIDED WITHIN 250' OF WAYSIDE FACILITY.  
 2. SEE SHEETS TT-D1052 TO TT-D1060 FOR BNSF RELOCATION DETAILS.

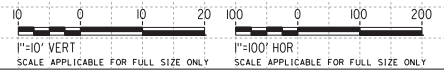
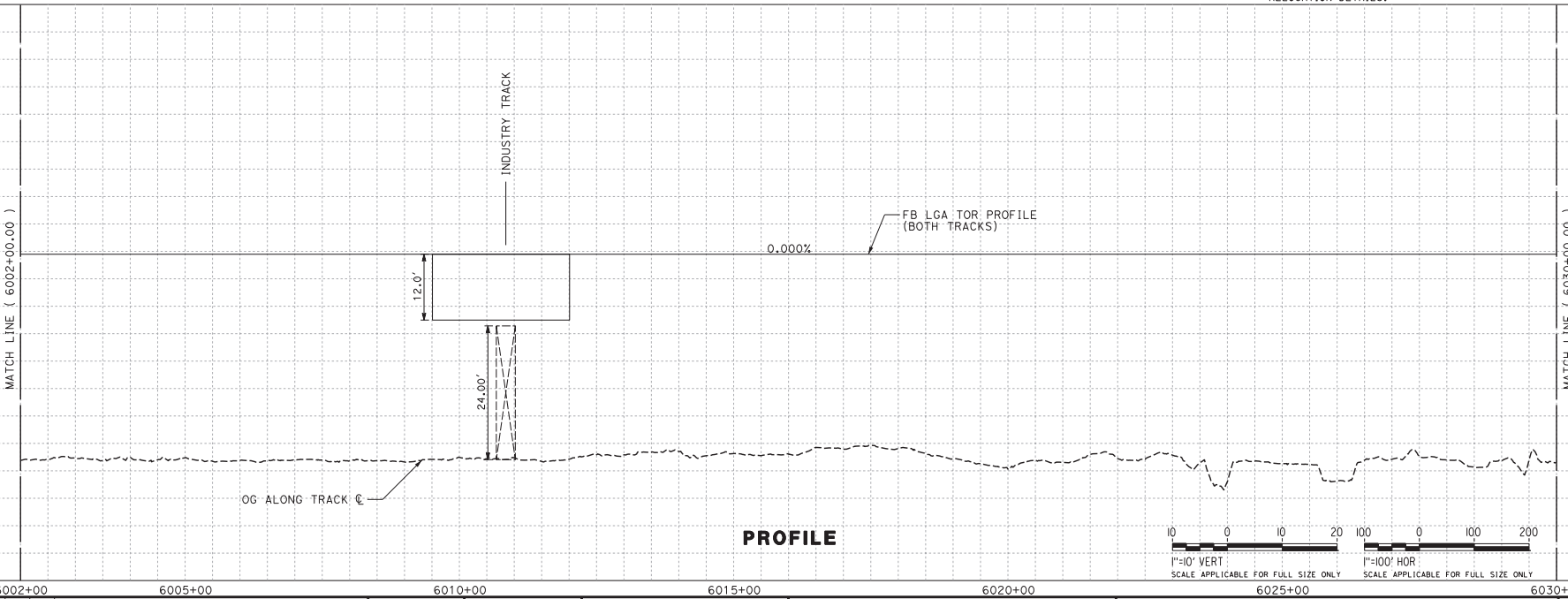

REV	DATE	BY	CHK	APP	DESCRIPTION

DESIGNED BY  
**J. TREJO**  
 DRAWN BY  
**T. WILKINSON**  
 CHECKED BY  
**E. WINTERS**  
 IN CHARGE  
**P. PIENTON**  
 DATE  
**10/28/2016**

**RECORD SET  
 PEPD DESIGN  
 SUBMISSION**

**TYLINT** INTERNATIONAL



**CALIFORNIA HIGH-SPEED RAIL PROJECT  
 FRESNO TO BAKERSFIELD  
 LOCALLY GENERATED ALTERNATIVE  
 TRACK GUIDEWAY  
 STA 6002+00 TO 6030+00  
 PROPOSED SOUND BARRIER**

CONTRACT NO.  
**HSR13-44**  
 DRAWING NO.  
**TT-D1006**  
 SCALE  
**AS SHOWN**  
 SHEET NO.

Projects\701206.N.BF55.00\_CADD\Sheet Files\Sound Barriers.BF55A-TT-D1028.dgn  
 #PENTBLS#  
 #PLTDRVS#  
 12/21/2016 10:00:05 PM

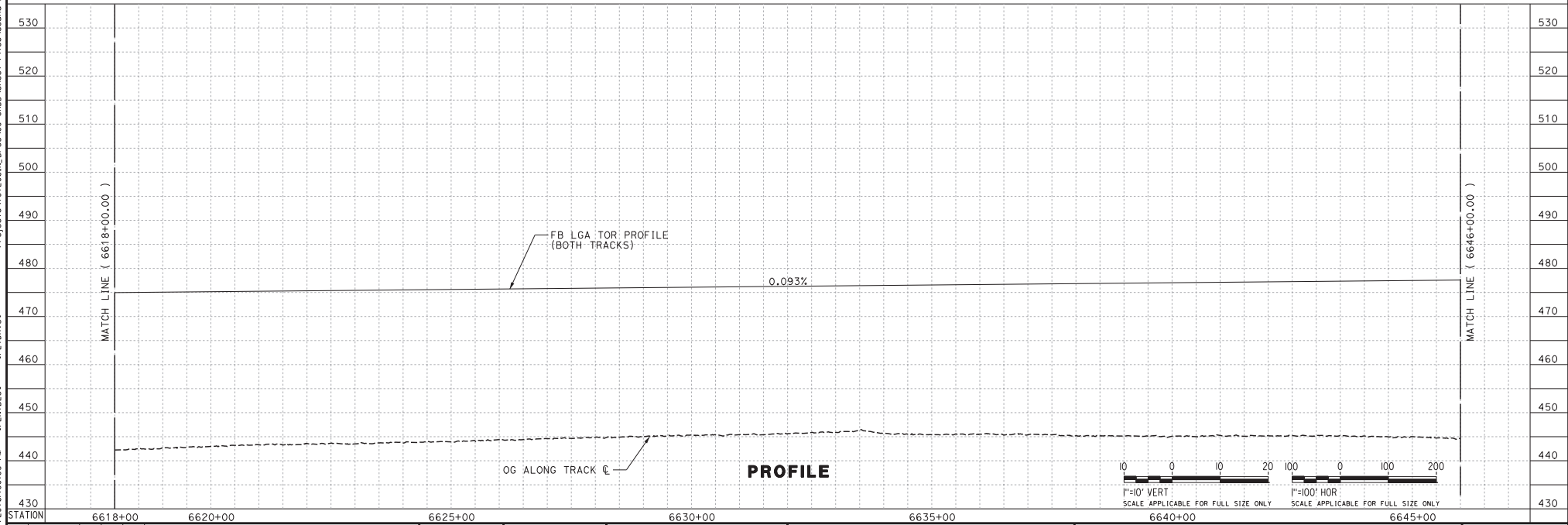
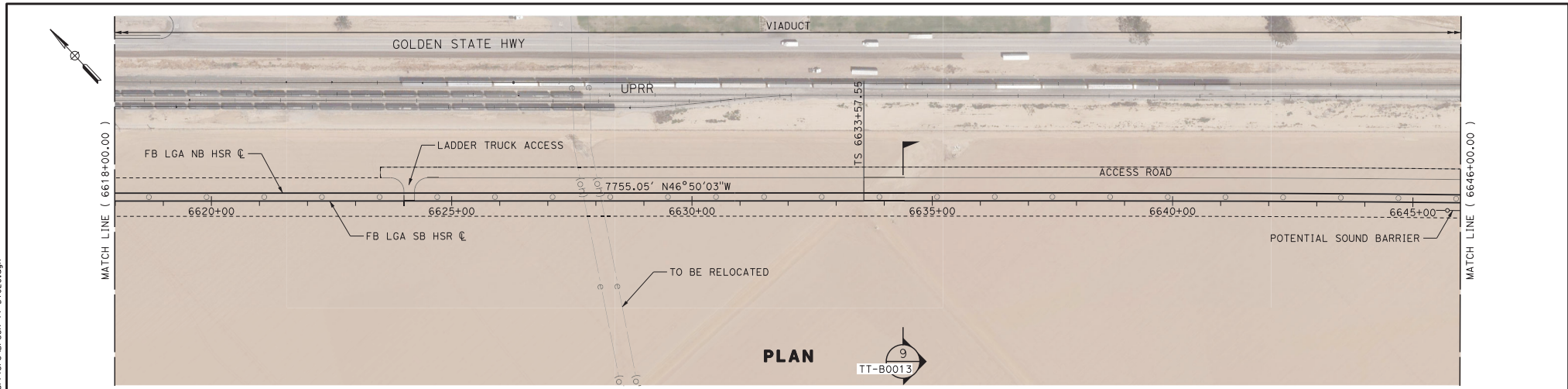

REV	DATE	BY	CHK	APP	DESCRIPTION

DESIGNED BY  
**J. TREJO**  
 DRAWN BY  
**T. WILKINSON**  
 CHECKED BY  
**E. WINTERS**  
 IN CHARGE  
**P. PIENTON**  
 DATE  
**10/28/2016**

**RECORD SET  
 PED DESIGN  
 SUBMISSION**



**CALIFORNIA HIGH-SPEED RAIL PROJECT**  
**FRESNO TO BAKERSFIELD**  
 LOCALLY GENERATED ALTERNATIVE  
 TRACK GUIDEWAY  
 STA 6618+00 TO 6646+00  
 PROPOSED SOUND BARRIER

CONTRACT NO.  
**HSR13-44**  
 DRAWING NO.  
**TT-D1028**  
 SCALE  
**AS SHOWN**  
 SHEET NO.

Projects\701206.N.BF55.00\_CADD\Sheet Files\Sound Barriers\BF55A-TT-D1029.dgn  
 #P:LTRVRS#  
 #P:ENTBLS#  
 12/21/2016 10:00:20 PM

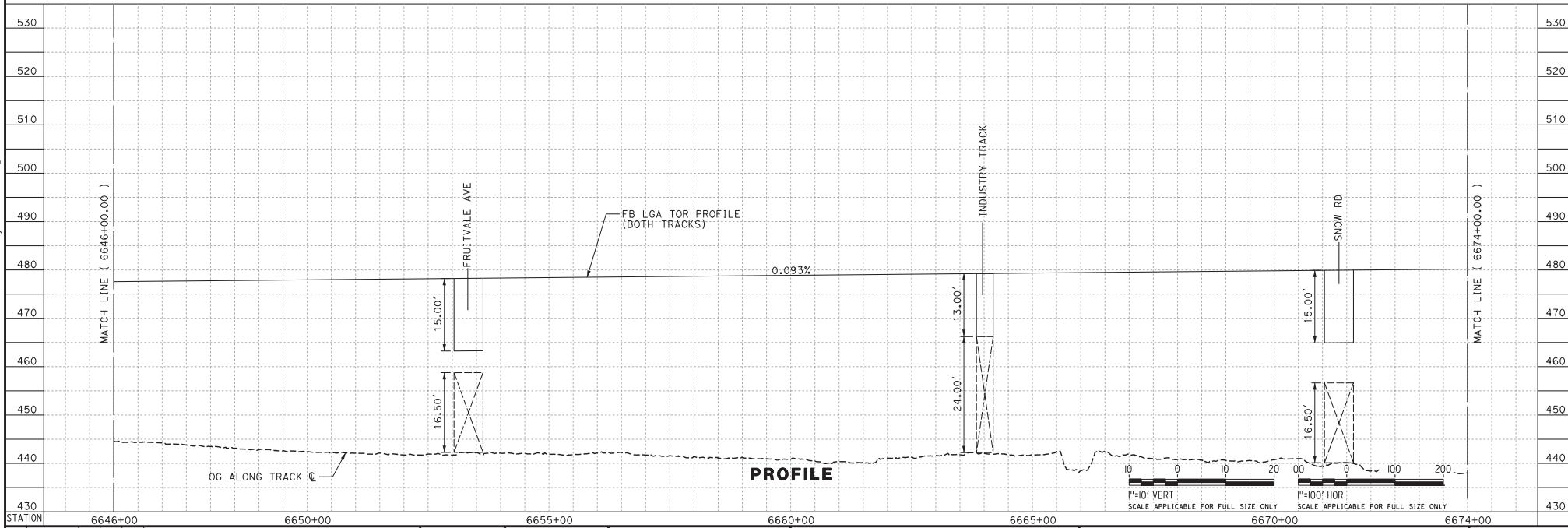
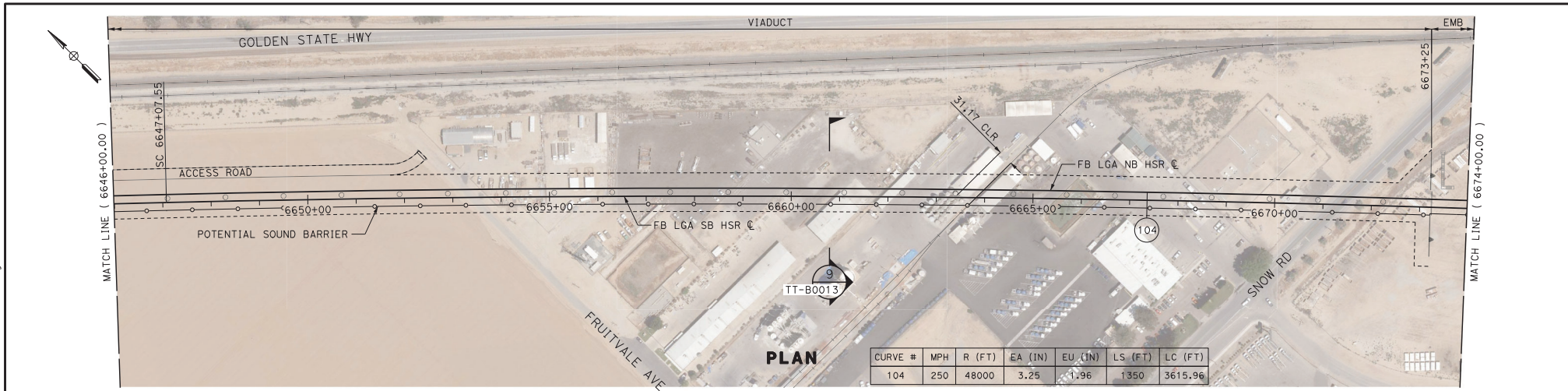

REV	DATE	BY	CHK	APP	DESCRIPTION

DESIGNED BY  
**J. TREJO**  
 DRAWN BY  
**T. WILKINSON**  
 CHECKED BY  
**E. WINTERS**  
 IN CHARGE  
**P. PIENTON**  
 DATE  
**10/28/2016**

**RECORD SET  
 PED DESIGN  
 SUBMISSION**



**CALIFORNIA HIGH-SPEED RAIL PROJECT**  
**FRESNO TO BAKERSFIELD**  
 LOCALLY GENERATED ALTERNATIVE  
 TRACK GUIDEWAY  
 STA 6646+00 TO 6674+00  
 PROPOSED SOUND BARRIER

CONTRACT NO.  
**HSR13-44**  
 DRAWING NO.  
**TT-D1029**  
 SCALE  
**AS SHOWN**  
 SHEET NO.

Projects\701206.N.BF55.00\_CADD\Sheet Files\Sound Barriers\BF55A-TT-D1030.dgn  
 #P:LTDRV68  
 #P:ENTBLS6  
 #P:ENTBLS6  
 12/21/2016 10:00:25 PM

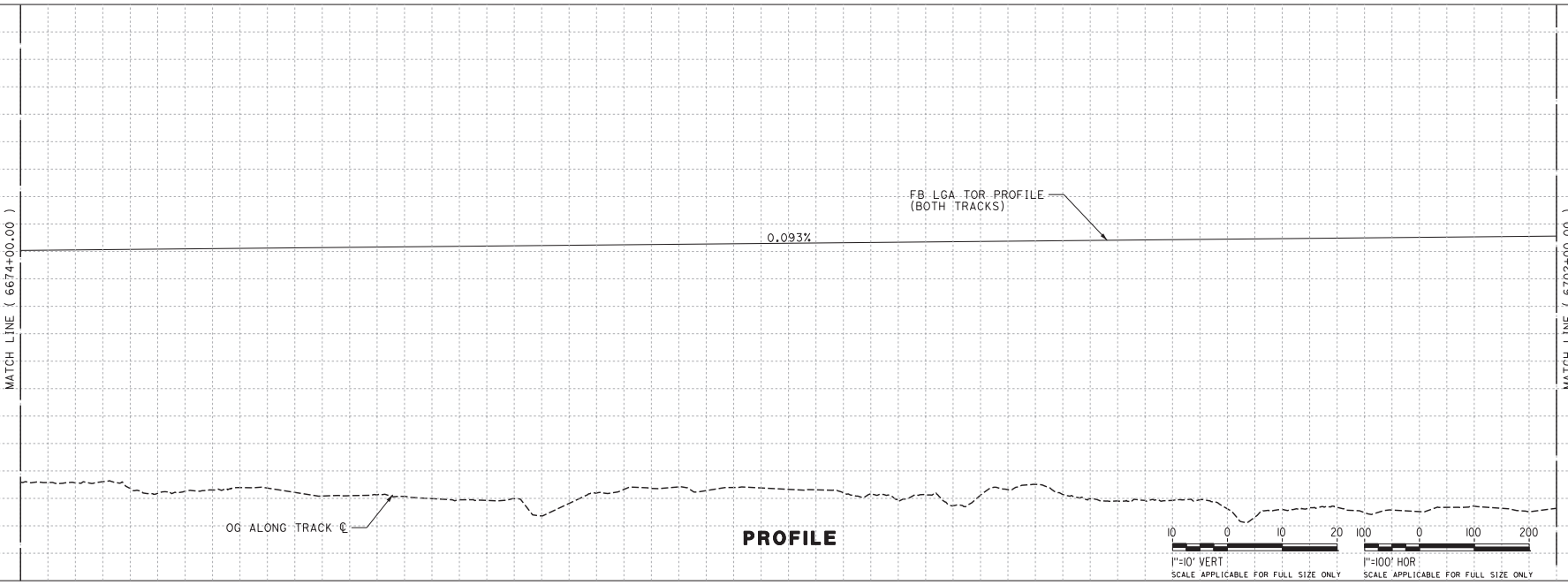
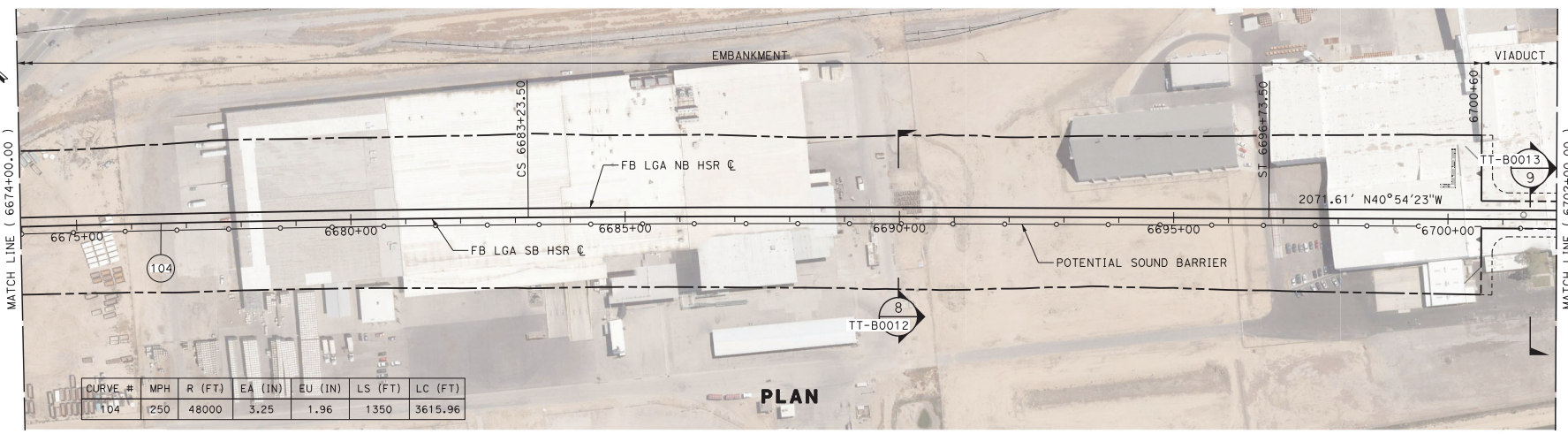

STATION	6675+00	6680+00	6685+00	6690+00	6695+00	6700+00	6702+00
DESIGNED BY	J. TREJO						
DRAWN BY	N. OLINO						
CHECKED BY	E. WINTERS						
IN CHARGE	P. PIENTON						
DATE	10/28/2016						
REV	DATE	BY	CHK	APP	DESCRIPTION		

**RECORD SET  
PED DESIGN  
SUBMISSION**

**CALIFORNIA HIGH-SPEED RAIL PROJECT  
FRESNO TO BAKERSFIELD**  
 LOCALLY GENERATED ALTERNATIVE  
 TRACK GUIDEWAY  
 STA 6674+00 TO 6702+00  
 PROPOSED SOUND BARRIER

CONTRACT NO.  
HSR13-44  
 DRAWING NO.  
TT-D1030  
 SCALE  
AS SHOWN  
 SHEET NO.

Projects\701206.N.BF55.00\_CADD\Sheet Files\Sound Barriers\BF55A-TT-D1031.dgn

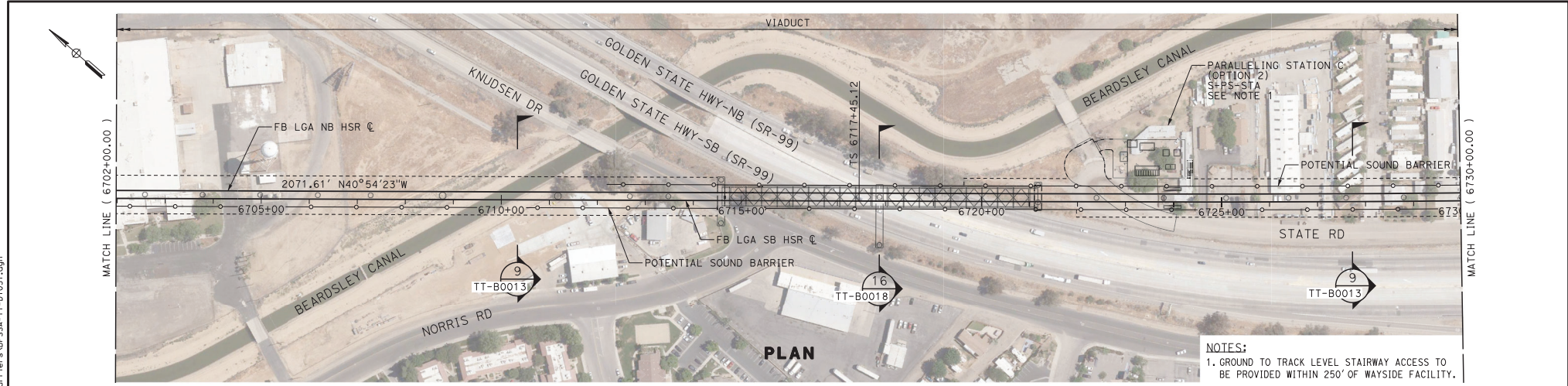

**NOTES:**  
 1. GROUND TO TRACK LEVEL STAIRWAY ACCESS TO BE PROVIDED WITHIN 250' OF WAYSIDE FACILITY.

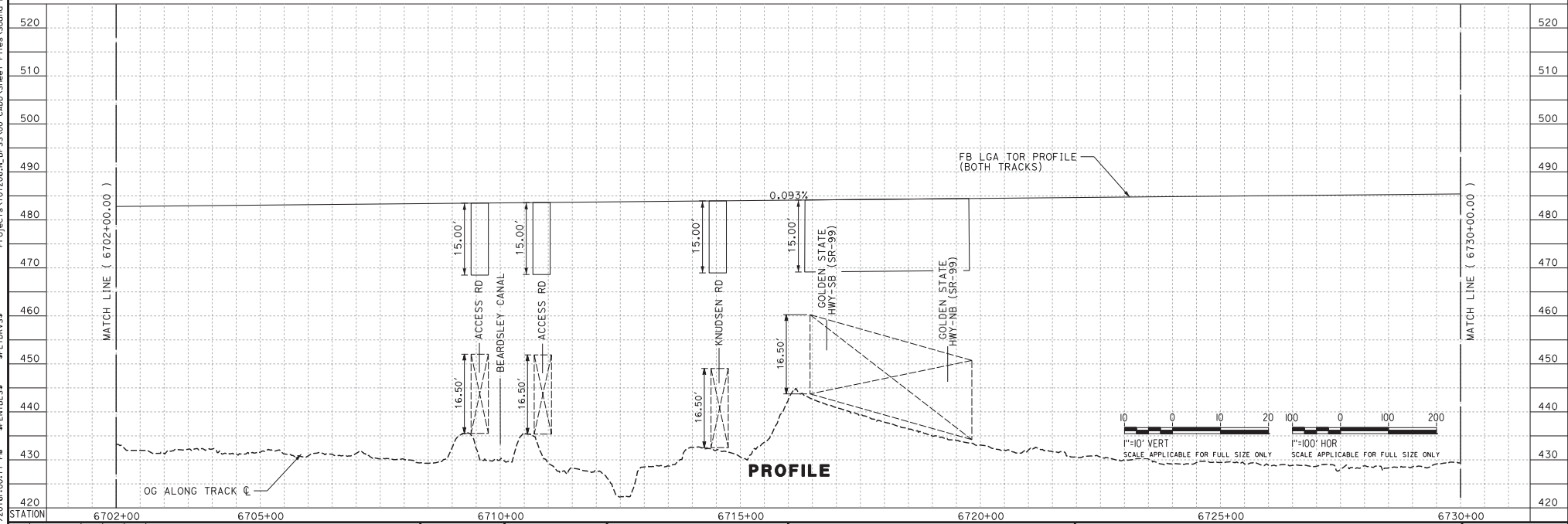

REV	DATE	BY	CHK	APP	DESCRIPTION

DESIGNED BY  
**J. TREJO**  
 DRAWN BY  
**N. OLINO**  
 CHECKED BY  
**E. WINTERS**  
 IN CHARGE  
**P. PINTON**  
 DATE  
**10/28/2016**

**RECORD SET  
 PEPD DESIGN  
 SUBMISSION**

**TYLIN INTERNATIONAL**



**CALIFORNIA HIGH-SPEED RAIL PROJECT**  
**FRESNO TO BAKERSFIELD**  
 LOCALLY GENERATED ALTERNATIVE  
 TRACK GUIDEWAY  
 STA 6702+00 TO 6730+00  
 PROPOSED SOUND BARRIER

CONTRACT NO.  
HSR13-44  
 DRAWING NO.  
TT-D1031  
 SCALE  
AS SHOWN  
 SHEET NO.

Projects\701206.N.B\F55.00\_CADD\Sheet Files\Sound Barriers\BFS5A-TT-D1032.dgn  
 #P:LDIVS#  
 #P:ENTBLS#  
 12/21/2016 10:00:28 PM  
 T:\N\Trejo

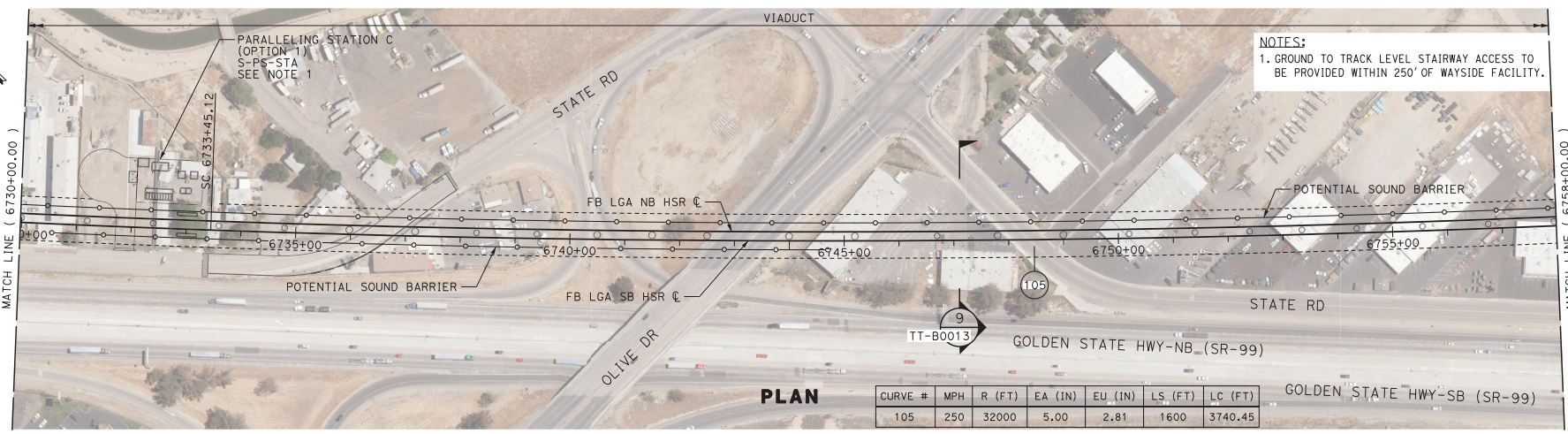

**NOTES:**  
 1. GROUND TO TRACK LEVEL STAIRWAY ACCESS TO BE PROVIDED WITHIN 250' OF WAYSIDE FACILITY.

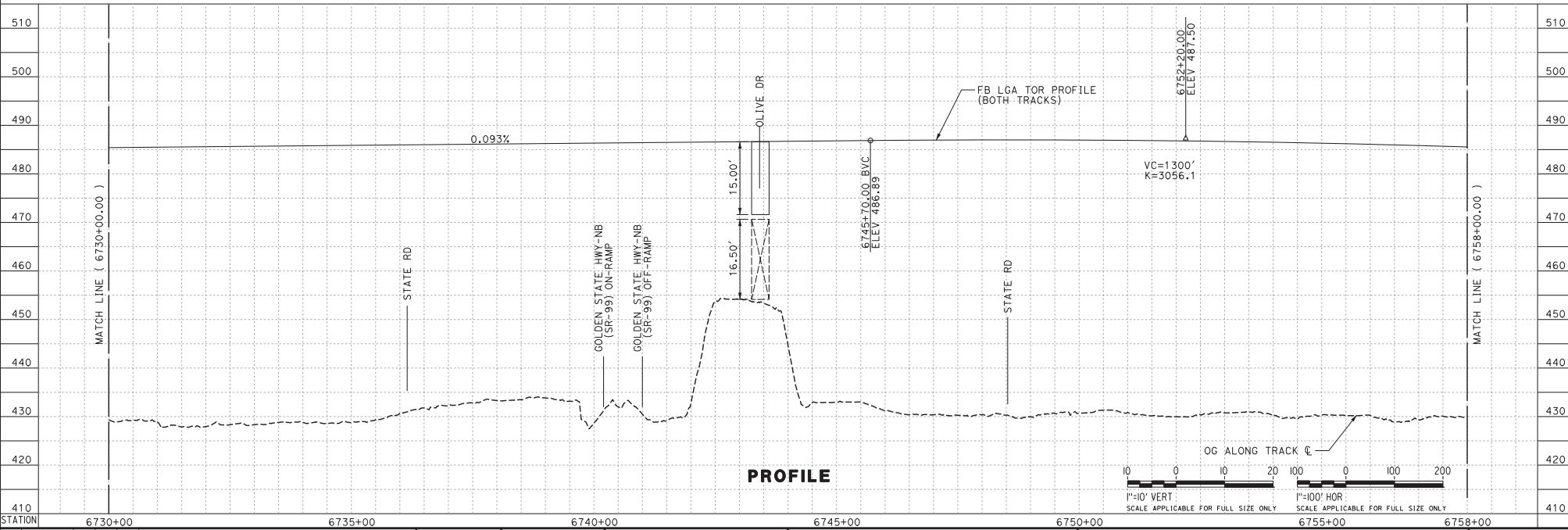

REV	DATE	BY	CHK	APP	DESCRIPTION

DESIGNED BY <b>J. TREJO</b> DRAWN BY <b>N. OLINO</b> CHECKED BY <b>E. WINTERS</b> IN CHARGE <b>P. PIENTON</b> DATE <b>10/28/2016</b>	<b>RECORD SET          PECD DESIGN          SUBMISSION</b>	<b>TYLINTINTERNATIONAL</b>	
---	--	----------------------------	---

<b>CALIFORNIA HIGH-SPEED RAIL PROJECT</b> <b>FRESNO TO BAKERSFIELD</b> LOCALLY GENERATED ALTERNATIVE TRACK GUIDEWAY STA 6730+00 TO 6758+00 PROPOSED SOUND BARRIER	CONTRACT NO. <b>HSR13-44</b> DRAWING NO. <b>TT-D1032</b> SCALE <b>AS SHOWN</b> SHEET NO.
--	--



Projects\701206\N.BF55.00\_CADD\Sheet Files\Sound Barriers\BFA-TT-D1033.dgn  
 #PLTDRVS#  
 #PENTBLS#  
 12/21/2016 10:00:24 PM  
 TYL\JTrejo

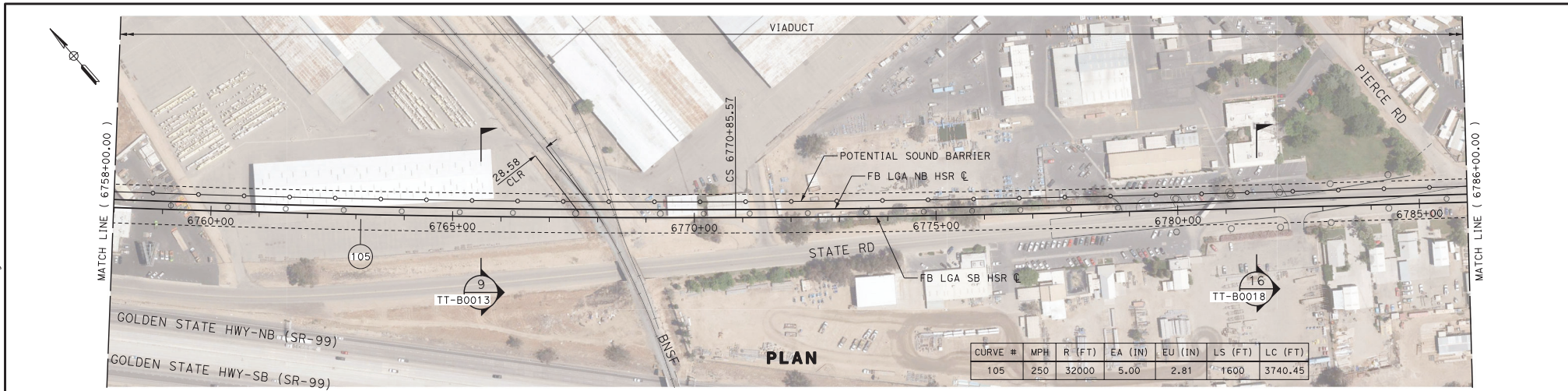

CURVE #	MPH	R (FT)	EA (IN)	EU (IN)	LS (FT)	LC (FT)
105	250	32000	5.00	2.81	1600	3740.45

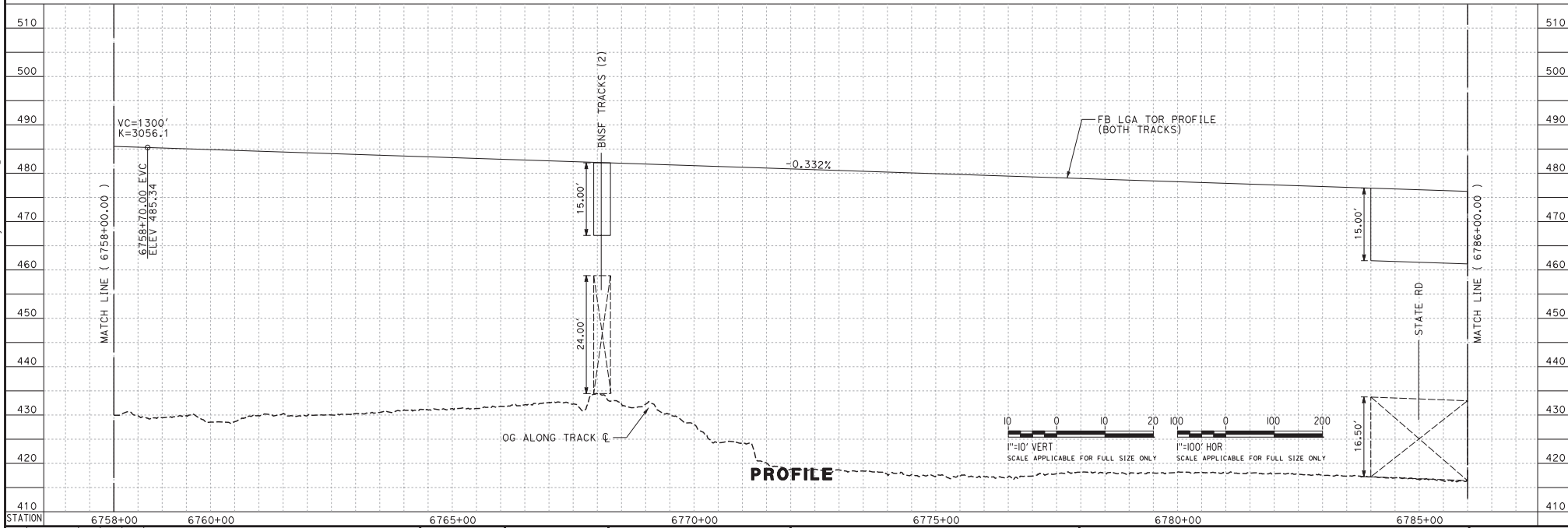

REV	DATE	BY	CHK	APP	DESCRIPTION

DESIGNED BY  
J. TREJO  
 DRAWN BY  
N. OLINO  
 CHECKED BY  
E. WINTERS  
 IN CHARGE  
P. PIENTON  
 DATE  
10/28/2016

**RECORD SET  
 PEDD DESIGN  
 SUBMISSION**



**CALIFORNIA HIGH-SPEED RAIL PROJECT**  
**FRESNO TO BAKERSFIELD**  
 LOCALLY GENERATED ALTERNATIVE  
 TRACK GUIDEWAY  
 STA 6758+00 TO 6786+00  
 PROPOSED SOUND BARRIER

CONTRACT NO.  
HSR13-44  
 DRAWING NO.  
TT-D1033  
 SCALE  
AS SHOWN  
 SHEET NO.

Projects\701206.N.BF55.00\_CADD\Sheet Files\Sound Barriers\BF55A-TT-D1034.dgn

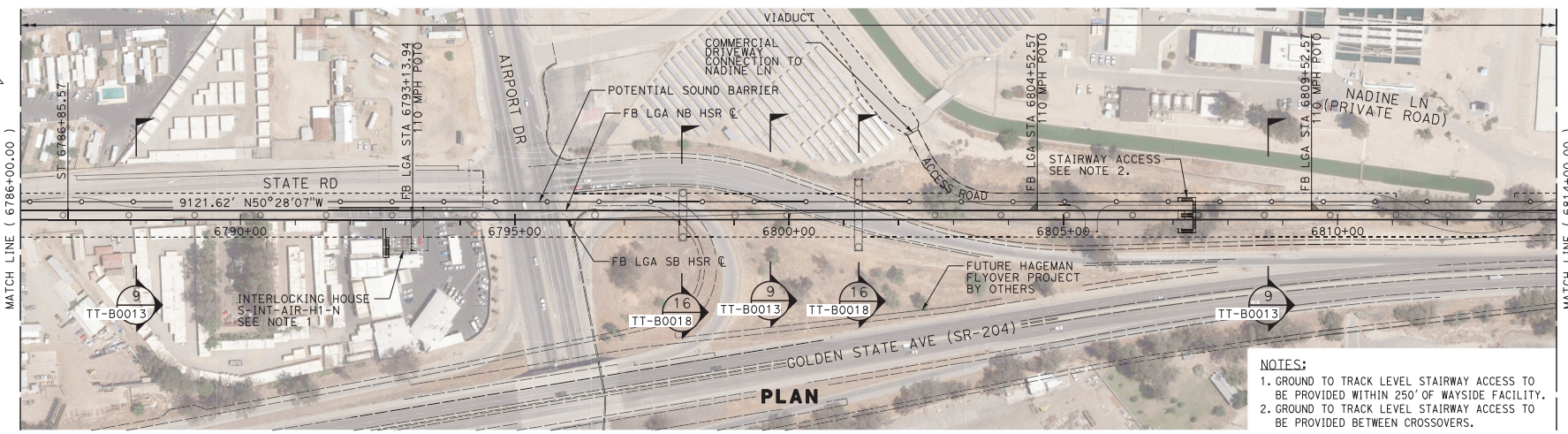

- NOTES:**
- GROUND TO TRACK LEVEL STAIRWAY ACCESS TO BE PROVIDED WITHIN 250' OF WAYSIDE FACILITY.
  - GROUND TO TRACK LEVEL STAIRWAY ACCESS TO BE PROVIDED BETWEEN CROSSOVERS.

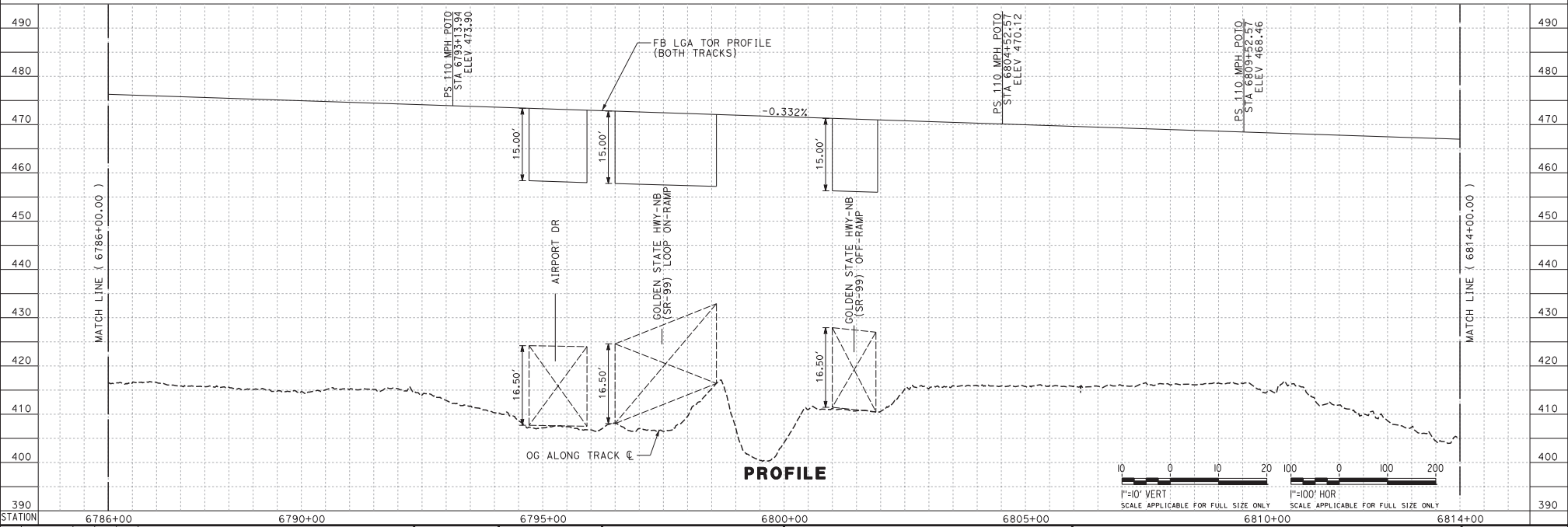

REV	DATE	BY	CHK	APP	DESCRIPTION

DESIGNED BY  
**J. TREJO**  
DRAWN BY  
**N. OLINO**  
CHECKED BY  
**E. WINTERS**  
IN CHARGE  
**P. PIENTON**  
DATE  
**10/28/2016**

**RECORD SET  
PEPD DESIGN  
SUBMISSION**



**CALIFORNIA HIGH-SPEED RAIL PROJECT  
FRESNO TO BAKERSFIELD**  
LOCALLY GENERATED ALTERNATIVE  
TRACK GUIDEWAY  
STA 6786+00 TO 6814+00  
PROPOSED SOUND BARRIER

CONTRACT NO.  
**HSR13-44**  
DRAWING NO.  
**TT-D1034**  
SCALE  
**AS SHOWN**  
SHEET NO.



Projects\701206.N.BF55.00\_CADD\Sheet Files\Sound Barriers\BFA-TT-D1036.dgn #PENTBL\$# #PLTDRV\$# 12/21/2016 10:00:36 PM

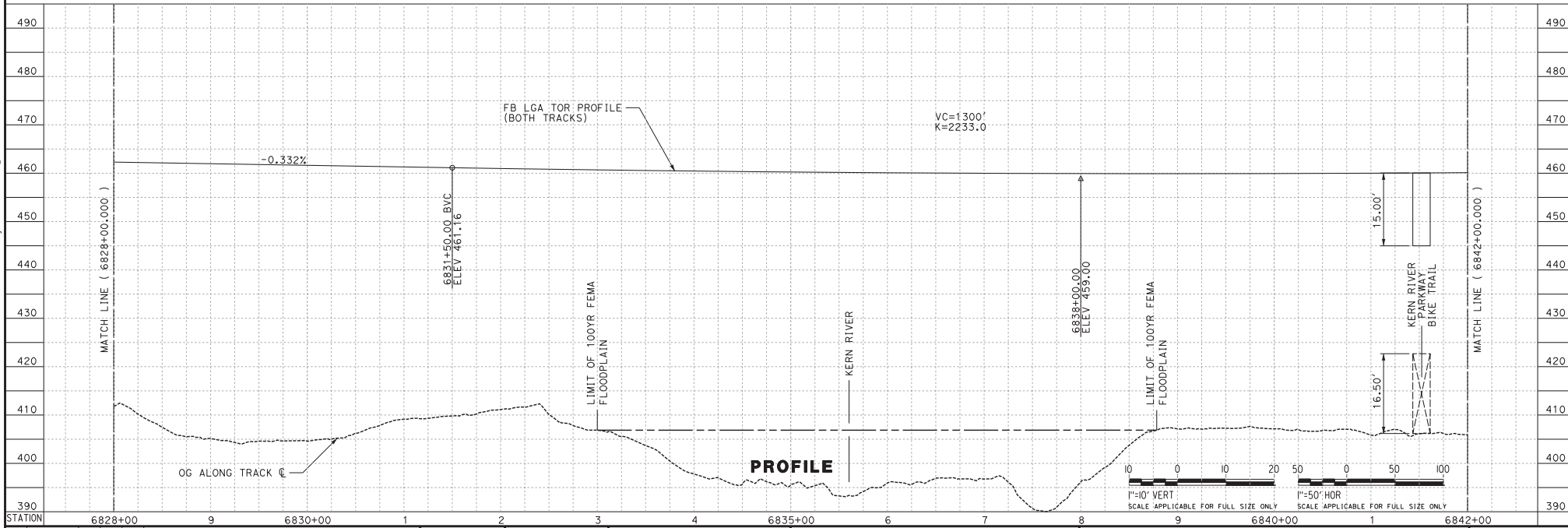
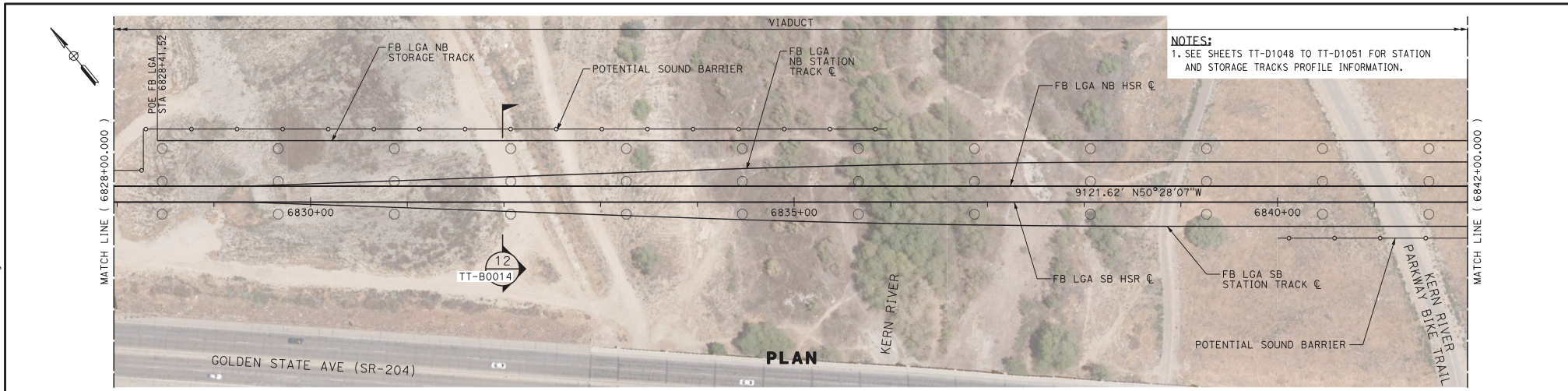

REV	DATE	BY	CHK	APP	DESCRIPTION

DESIGNED BY  
**J. TREJO**  
DRAWN BY  
**J. TREJO**  
CHECKED BY  
**E. WINTERS**  
IN CHARGE  
**P. PIENTON**  
DATE  
**10/28/2016**

**RECORD SET  
PEPD DESIGN  
SUBMISSION**



**CALIFORNIA HIGH-SPEED RAIL PROJECT  
FRESNO TO BAKERSFIELD  
LOCALLY GENERATED ALTERNATIVE  
TRACK GUIDEWAY  
STA 6828+00 TO 6842+00  
PROPOSED SOUND BARRIER**

CONTRACT NO.  
**HSR13-44**  
DRAWING NO.  
**TT-D1036**  
SCALE  
**AS SHOWN**  
SHEET NO.

Projects\701206.N.BF55.00\_CADD\Sheet Files\Sound Barriers\BFA-SA-TT-D1037.dgn  
 #P:LTDRVRS#  
 #P:ENTBLS#  
 12/21/2016 10:10:11 PM  
 TYL\JTrejo

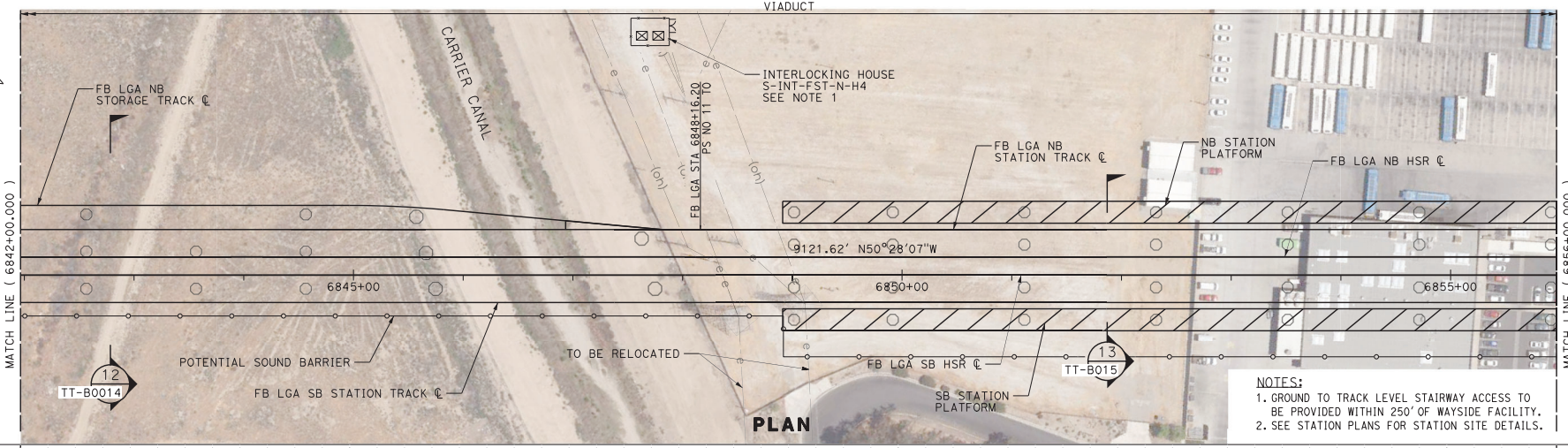

**NOTES:**  
 1. GROUND TO TRACK LEVEL STAIRWAY ACCESS TO BE PROVIDED WITHIN 250' OF WAYSIDE FACILITY.  
 2. SEE STATION PLANS FOR STATION SITE DETAILS.

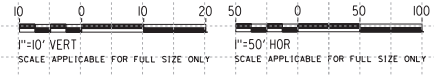
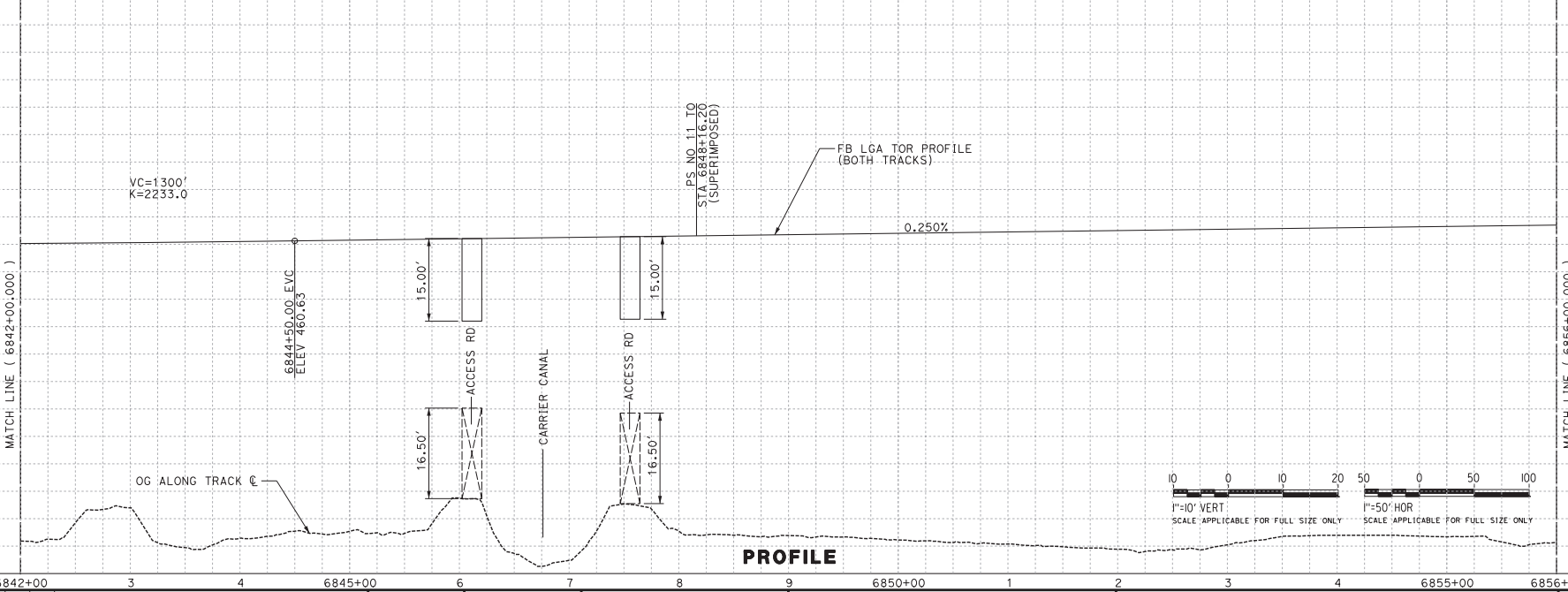

REV	DATE	BY	CHK	APP	DESCRIPTION

DESIGNED BY  
**J. TREJO**  
 DRAWN BY  
**J. TREJO**  
 CHECKED BY  
**E. WINTERS**  
 IN CHARGE  
**P. PIENTON**  
 DATE  
**10/28/2016**

**RECORD SET  
 PEDD DESIGN  
 SUBMISSION**

**TYLINTERNATIONAL**



**CALIFORNIA HIGH-SPEED RAIL PROJECT  
 FRESNO TO BAKERSFIELD**  
 LOCALLY GENERATED ALTERNATIVE  
 TRACK GUIDEWAY  
 STA 6842+00 TO 6856+00  
 PROPOSED SOUND BARRIER

CONTRACT NO.  
**HSR13-44**  
 DRAWING NO.  
**TT-D1037**  
 SCALE  
**AS SHOWN**  
 SHEET NO.



Projects\701206.N.BF55.00\_CADD\Sheet Files\Sound Barriers\BF55A-TT-D1039.dgn

#PLTDRVS#

#PENTBLS#

12/21/2016 10:00:41 PM

JTL\JTrejo

REV	DATE	BY	CHK	APP	DESCRIPTION

DESIGNED BY  
**J. TREJO**  
DRAWN BY  
**J. TREJO**  
CHECKED BY  
**E. WINTERS**  
IN CHARGE  
**P. PIENTON**  
DATE  
**10/28/2016**

**RECORD SET  
PEPD DESIGN  
SUBMISSION**

**TYLINT** INTERNATIONAL



**CALIFORNIA HIGH-SPEED RAIL PROJECT**  
**FRESNO TO BAKERSFIELD**  
LOCALLY GENERATED ALTERNATIVE  
TRACK GUIDEWAY  
STA 6870+00 TO 6884+00  
PROPOSED SOUND BARRIER

CONTRACT NO.  
HSR13-44  
DRAWING NO.  
TT-D1039  
SCALE  
AS SHOWN  
SHEET NO.

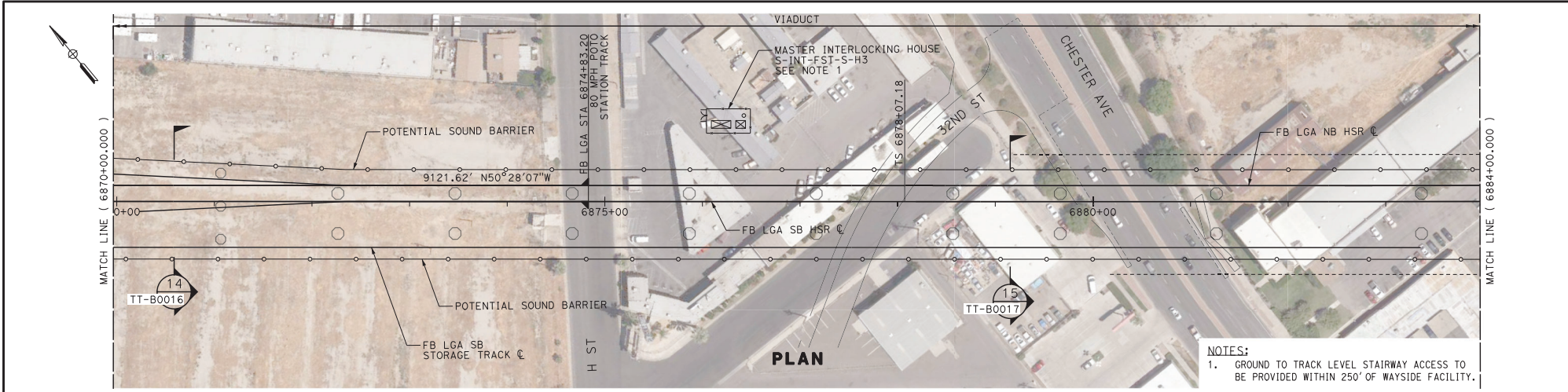

**NOTES:**  
1. GROUND TO TRACK LEVEL STAIRWAY ACCESS TO BE PROVIDED WITHIN 250' OF WAYSIDE FACILITY.

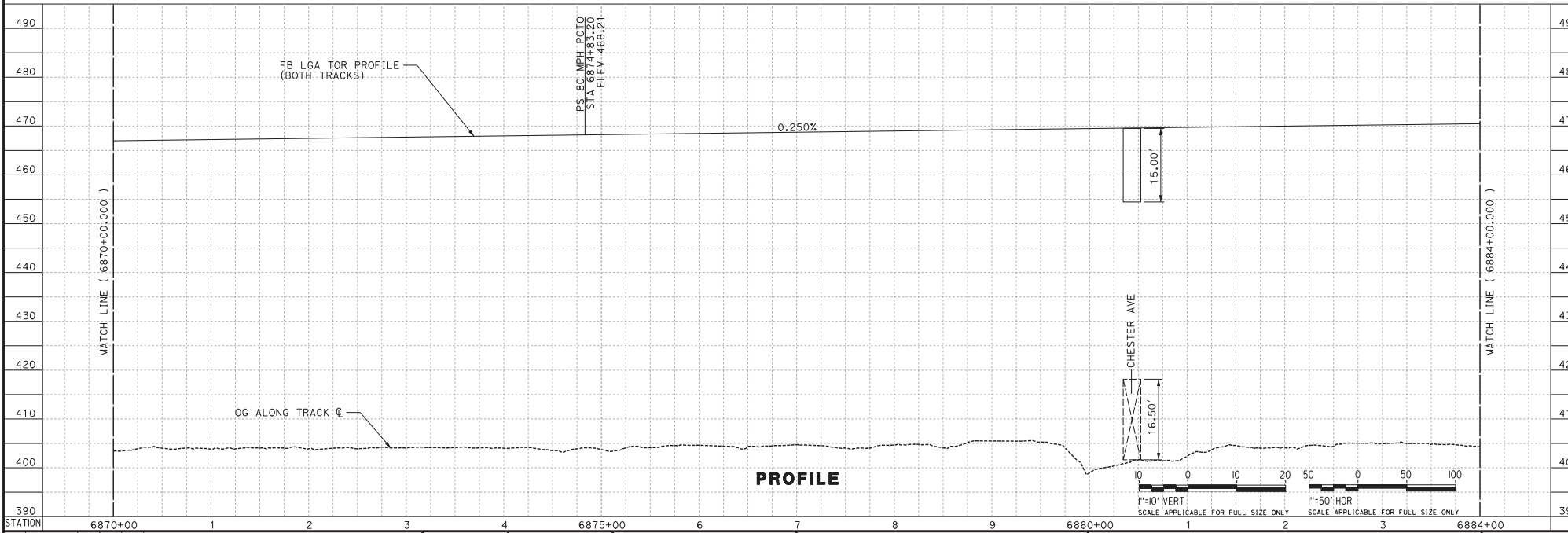

Projects\701206.N.BF55.00\_CADD\Sheet Files\Sound Barriers\BF55A-TT-D1039.dgn

Projects\701206\N.BF55.00\_CADD\Sheet Files\Sound Barriers\BF55A-TT-D1040.dgn  
 #PENTBLS#  
 #PLTDRVS#  
 12/21/2016 10:00:57 PM

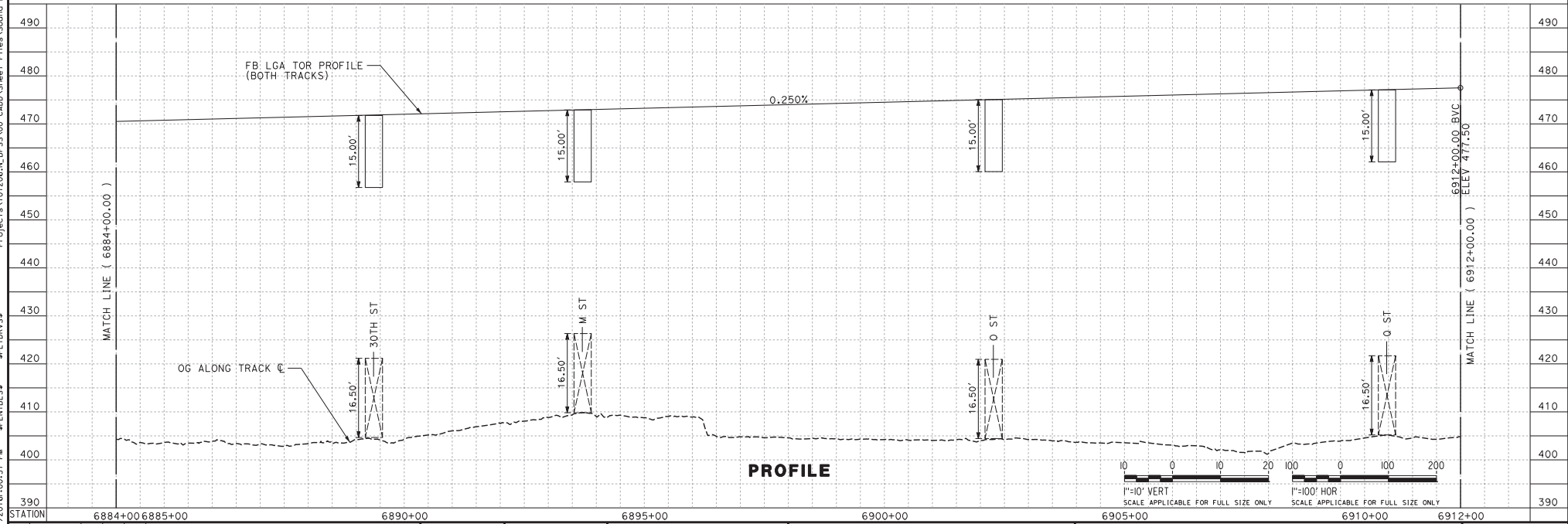
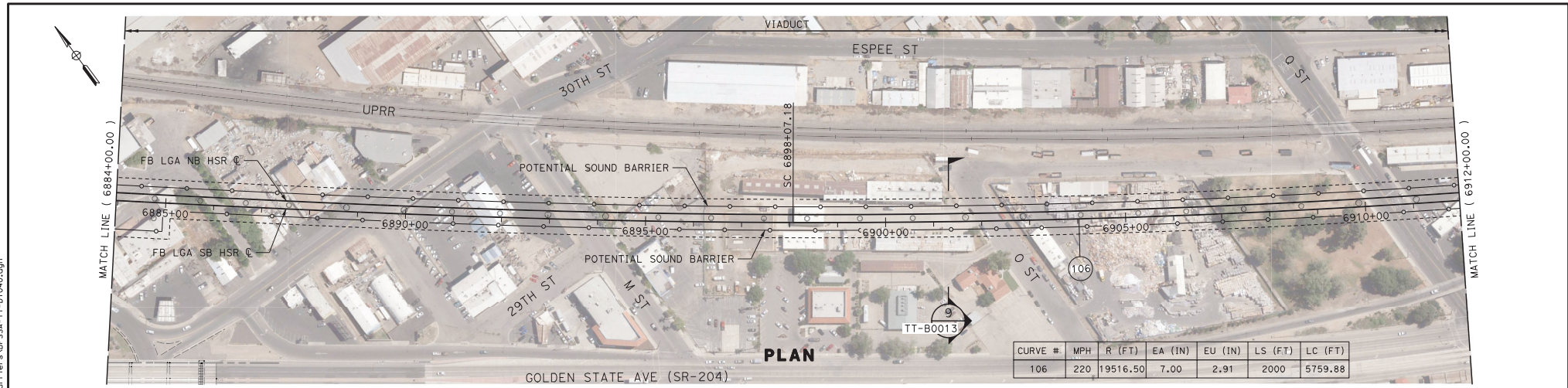

REV	DATE	BY	CHK	APP	DESCRIPTION

DESIGNED BY  
J. TREJO  
 DRAWN BY  
J. TREJO  
 CHECKED BY  
E. WINTERS  
 IN CHARGE  
P. PIENTON  
 DATE  
10/28/2016

**RECORD SET  
 PEPD DESIGN  
 SUBMISSION**

**TYLIN INTERNATIONAL**



**CALIFORNIA HIGH-SPEED RAIL PROJECT**  
**FRESNO TO BAKERSFIELD**  
 LOCALLY GENERATED ALTERNATIVE  
 TRACK GUIDEWAY  
 STA 6884+00 TO 6912+00  
 PROPOSED SOUND BARRIER

CONTRACT NO.  
HSR13-44  
 DRAWING NO.  
TT-D1040  
 SCALE  
AS SHOWN  
 SHEET NO.



Projects\701206.N.BF55.00 CAD Sheet Files\Sound Barriers\BF55A-TT-D1041.dgn

TYL\JTrejo 12/21/2016 10:01:12 PM #PENTBL5# #PLTDIV5#

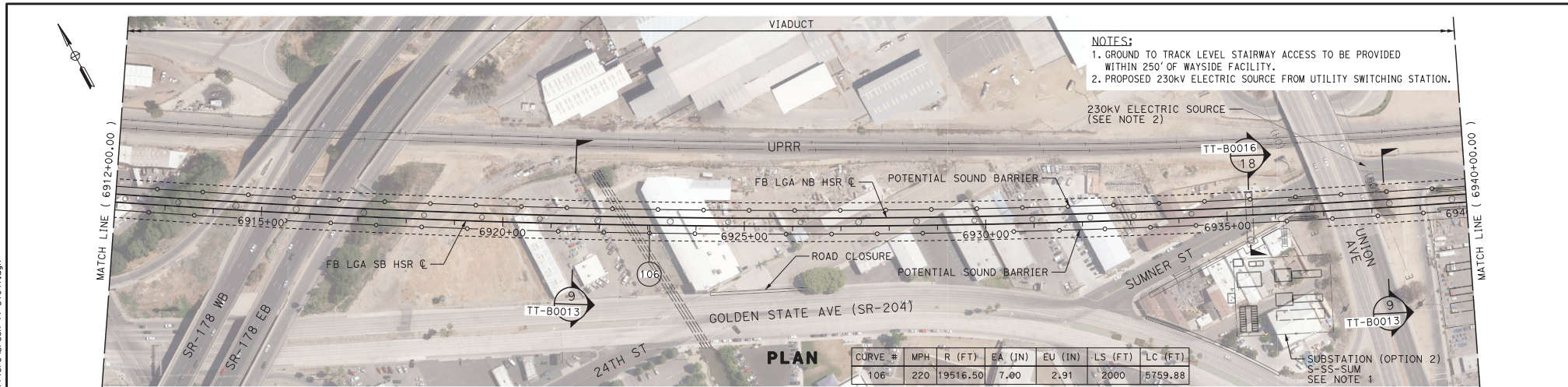

CURVE #	MPH	R (FT)	EA (IN)	EU (IN)	LS (FT)	LC (FT)
106	220	19516.50	7.00	2.91	2000	5759.88

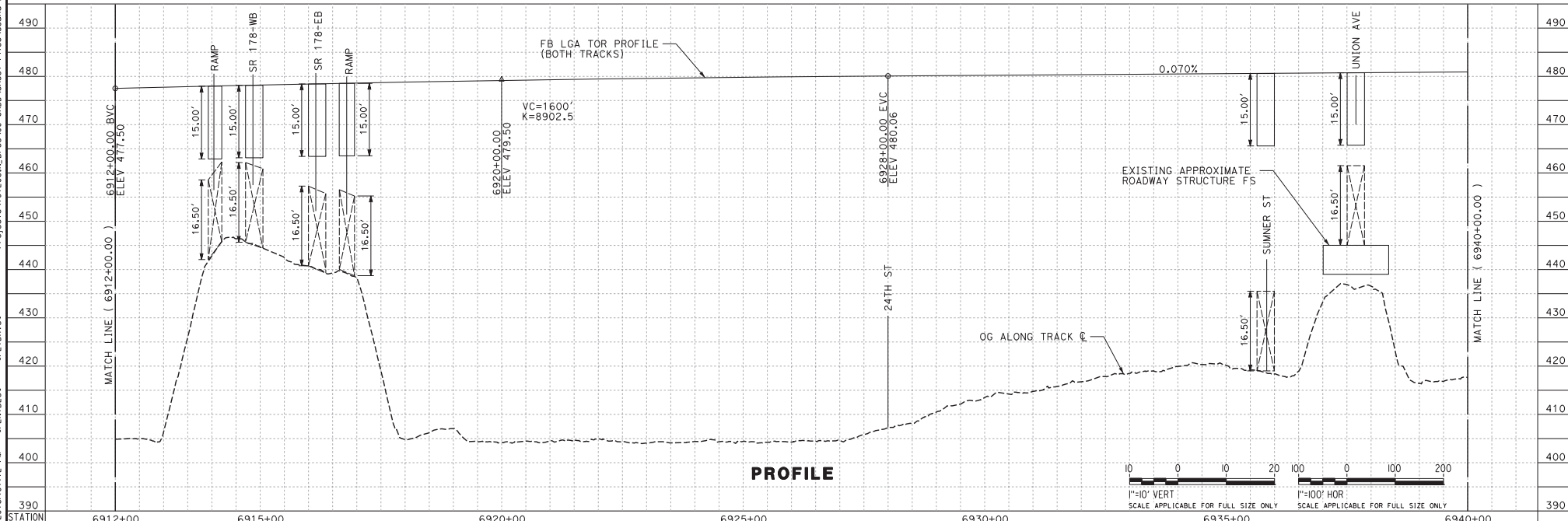

REV	DATE	BY	CHK	APP	DESCRIPTION

DESIGNED BY  
J. TREJO  
 DRAWN BY  
J. TREJO  
 CHECKED BY  
E. WINTERS  
 IN CHARGE  
P. PIENTON  
 DATE  
10/28/2016

**RECORD SET  
 PEDD DESIGN  
 SUBMISSION**

**TYLIN INTERNATIONAL**



**CALIFORNIA HIGH-SPEED RAIL PROJECT**  
**FRESNO TO BAKERSFIELD**  
 LOCALLY GENERATED ALTERNATIVE  
 TRACK GUIDEWAY  
 STA 6912+00 TO 6940+00  
 PROPOSED SOUND BARRIER

CONTRACT NO.  
HSR13-44  
 DRAWING NO.  
TT-D1041  
 SCALE  
AS SHOWN  
 SHEET NO.

Projects\701206.N.BF55.00 CAD Sheet Files\Sound Barriers\BF55A-TT-D1042.dgn  
 #P:LTRVCS#  
 #P:ENTBLS#  
 T:\J\Trejo 12/21/2016 01:01:10 PM

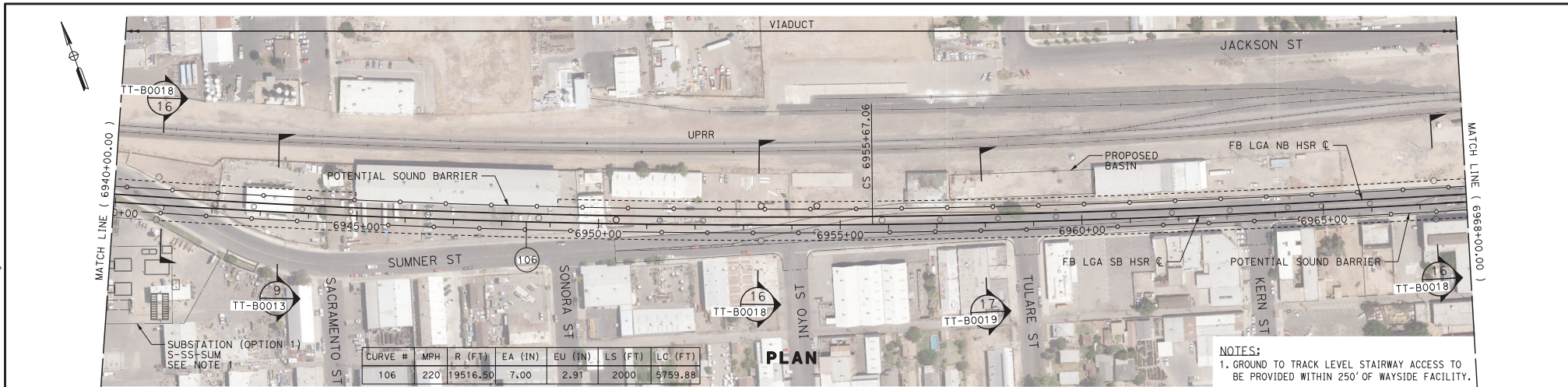

**NOTES:**  
 1. GROUND TO TRACK LEVEL STAIRWAY ACCESS TO BE PROVIDED WITHIN 250' OF WAYSIDE FACILITY.

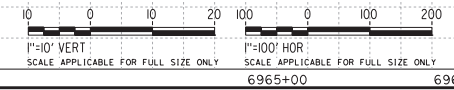
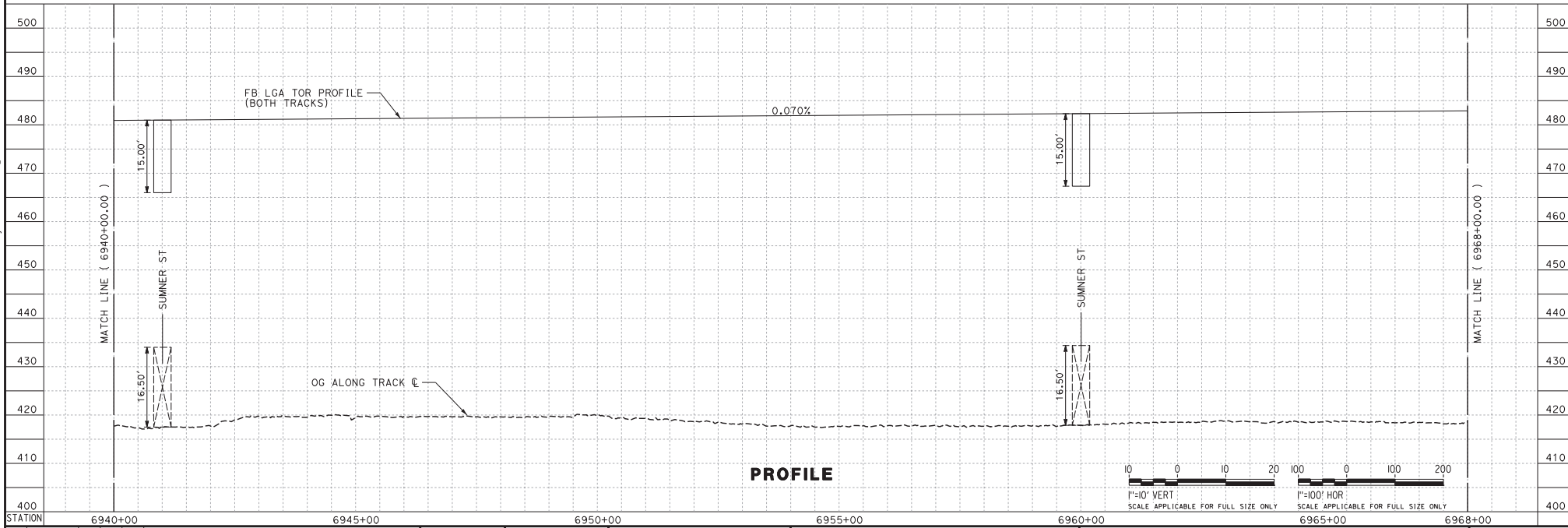

REV	DATE	BY	CHK	APP	DESCRIPTION

DESIGNED BY  
J. TREJO  
 DRAWN BY  
J. TREJO  
 CHECKED BY  
E. WINTERS  
 IN CHARGE  
P. PIENTON  
 DATE  
10/28/2016

**RECORD SET  
 PEDD DESIGN  
 SUBMISSION**



**CALIFORNIA HIGH-SPEED RAIL PROJECT**  
**FRESNO TO BAKERSFIELD**  
 LOCALLY GENERATED ALTERNATIVE  
 TRACK GUIDEWAY  
 STA 6940+00 TO 6968+00  
 PROPOSED SOUND BARRIER

CONTRACT NO.  
HSR13-44  
 DRAWING NO.  
TT-D1042  
 SCALE  
AS SHOWN  
 SHEET NO.

Projects\701206\N.BF55\00\_CADD\Sheet Files\Sound Barriers\BF55A-TT-D1043.dgn  
 #PENTBLS#  
 #PLTDRVS#  
 12/21/2016 10:01:08 PM  
 TYL\JTrejo

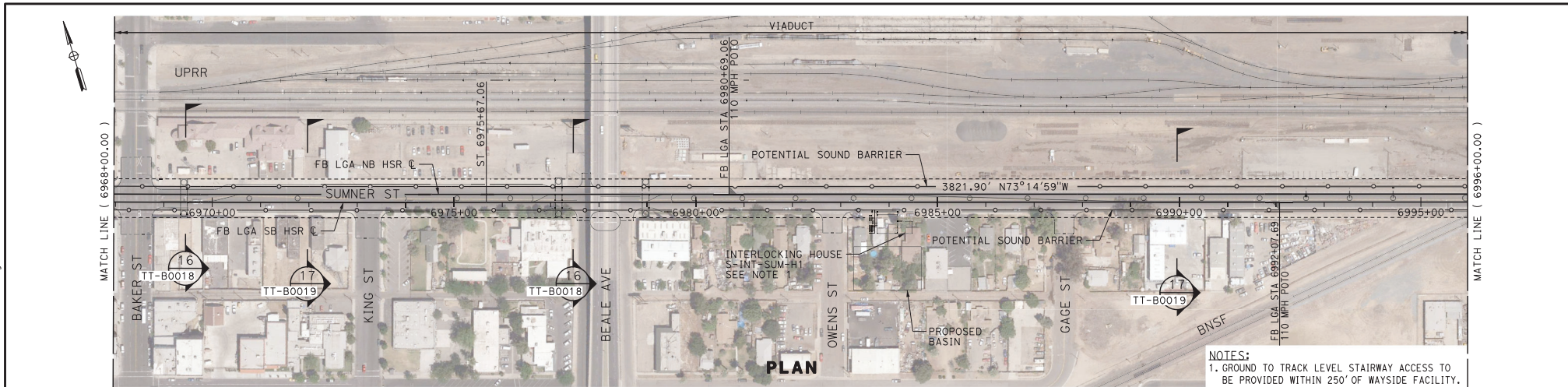

**NOTES:**  
 1. GROUND TO TRACK LEVEL STAIRWAY ACCESS TO BE PROVIDED WITHIN 250' OF WAYSIDE FACILITY.

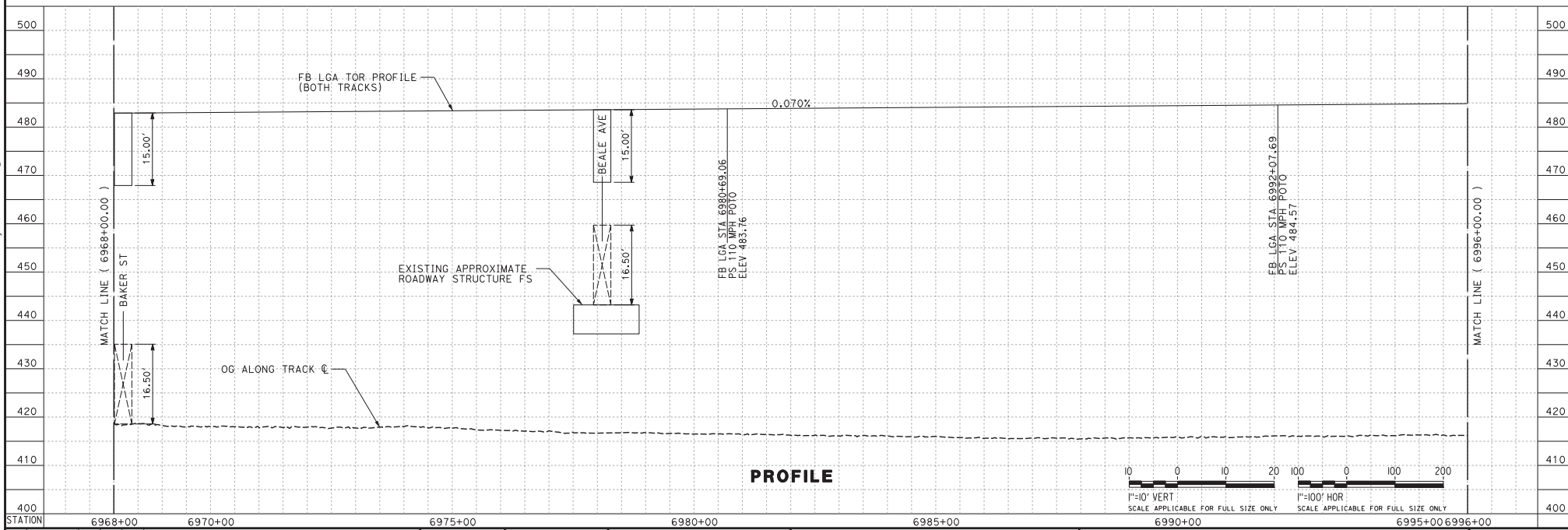

REV	DATE	BY	CHK	APP	DESCRIPTION

DESIGNED BY  
**J. TREJO**  
 DRAWN BY  
**J. TREJO**  
 CHECKED BY  
**E. WINTERS**  
 IN CHARGE  
**P. PIENTON**  
 DATE  
**10/28/2016**

**RECORD SET  
 PEDD DESIGN  
 SUBMISSION**



**CALIFORNIA HIGH-SPEED RAIL PROJECT**  
**FRESNO TO BAKERSFIELD**  
 LOCALLY GENERATED ALTERNATIVE  
 TRACK GUIDEWAY  
 STA 6968+00 TO 6996+00  
 PROPOSED SOUND BARRIER

CONTRACT NO.  
**HSR13-44**  
 DRAWING NO.  
**TT-D1043**  
 SCALE  
**AS SHOWN**  
 SHEET NO.

Projects\701206.N.BF55.00 CAD Sheet Files\Sound Barriers\BFA-TT-D1044.dgn

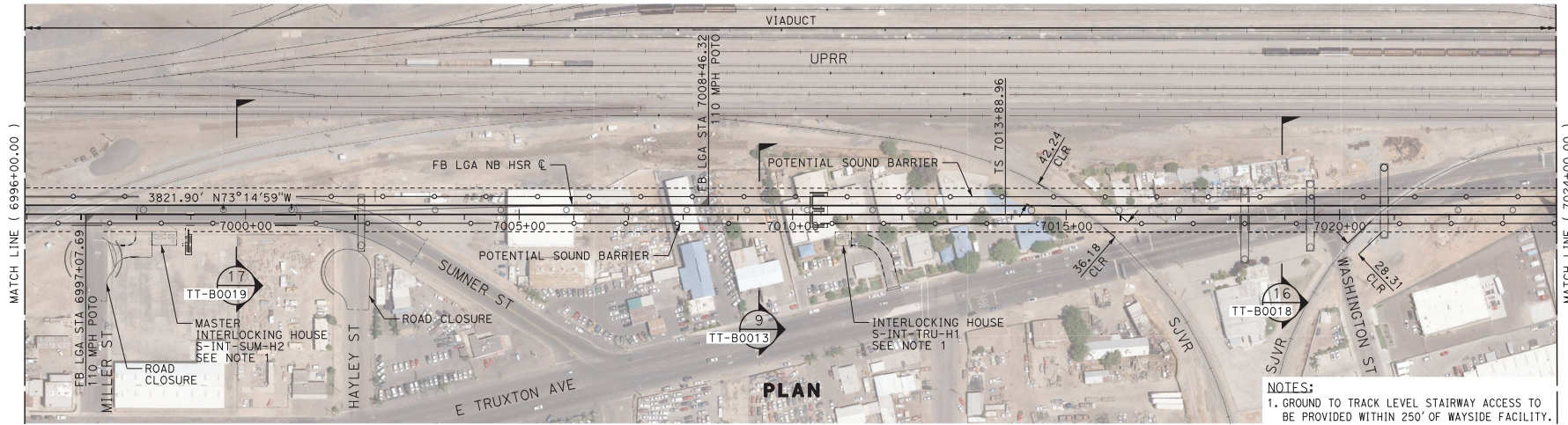

**PLAN**

**NOTES:**  
1. GROUND TO TRACK LEVEL STAIRWAY ACCESS TO BE PROVIDED WITHIN 250' OF WAYSIDE FACILITY.

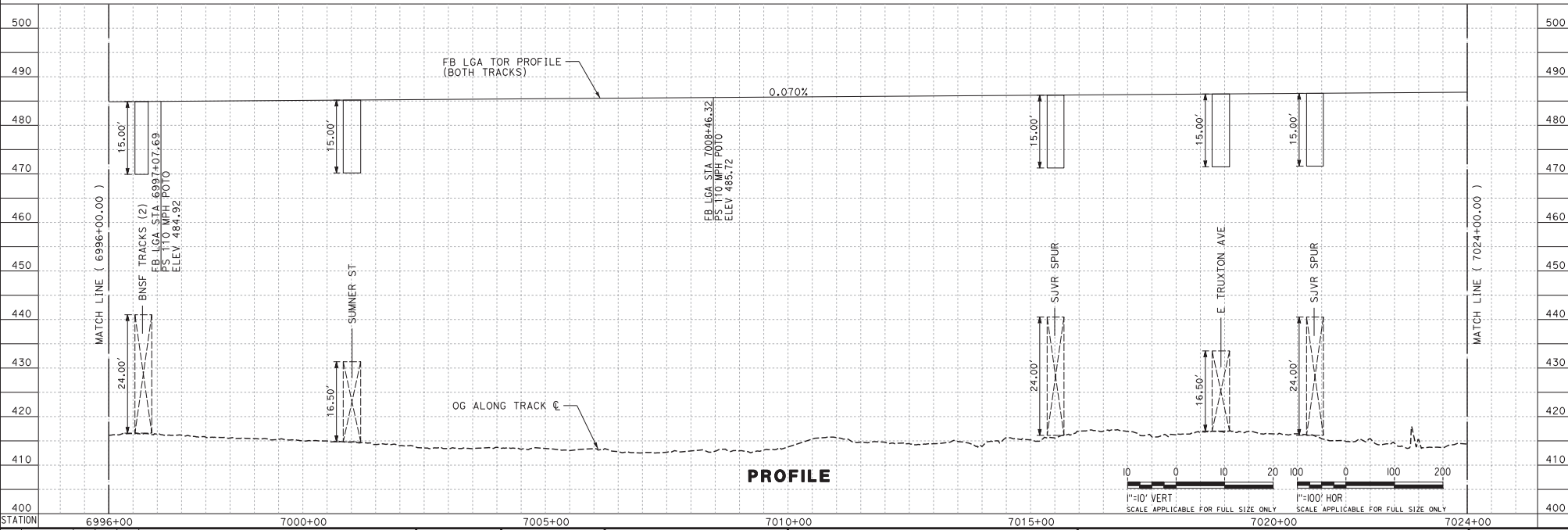

**PROFILE**

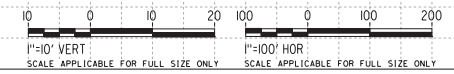

REV	DATE	BY	CHK	APP	DESCRIPTION

DESIGNED BY  
**J. TREJO**  
DRAWN BY  
**J. TREJO**  
CHECKED BY  
**E. WINTERS**  
IN CHARGE  
**P. PIENTON**  
DATE  
**10/28/2016**

**RECORD SET  
PEPD DESIGN  
SUBMISSION**



**CALIFORNIA HIGH-SPEED RAIL PROJECT  
FRESNO TO BAKERSFIELD  
LOCALLY GENERATED ALTERNATIVE  
TRACK GUIDEWAY  
STA 6996+00 TO 7024+00  
PROPOSED SOUND BARRIER**

CONTRACT NO.  
**HSR13-44**  
DRAWING NO.  
**TT-D1044**  
SCALE  
**AS SHOWN**  
SHEET NO.

Projects\701206.N.BF55.00 CAD Sheet Files\Sound Barriers\BF55A-TT-D1045.dgn  
 #PLOTDRWS#  
 #PENTBLS#  
 12/21/2016 10:11:21 PM  
 JTL\JTrejo

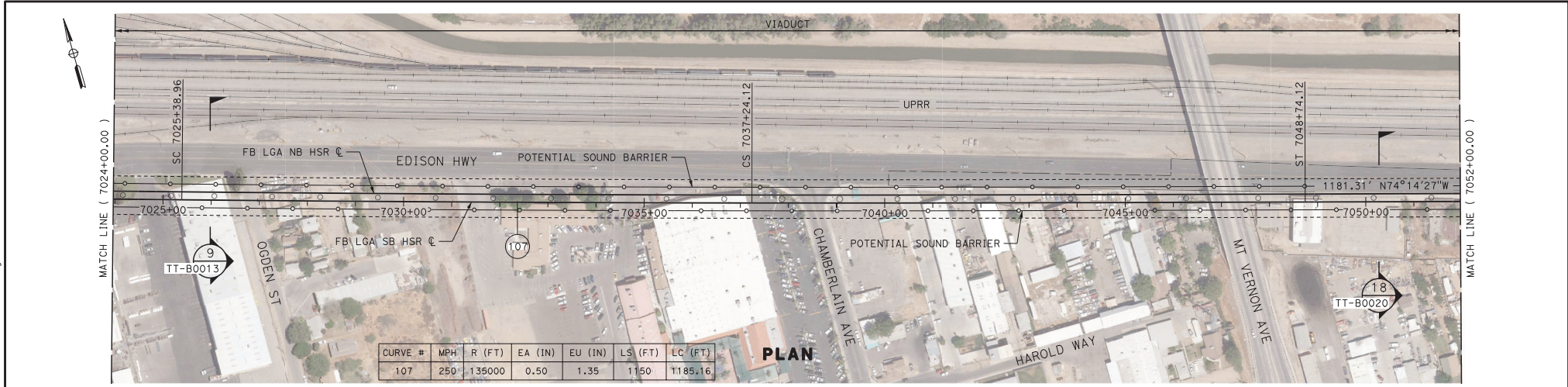

CURVE #	MPH	R (FT)	EA (IN)	EU (IN)	LS (FT)	LC (FT)
107	250	135000	0.50	1.35	1150	1185.16

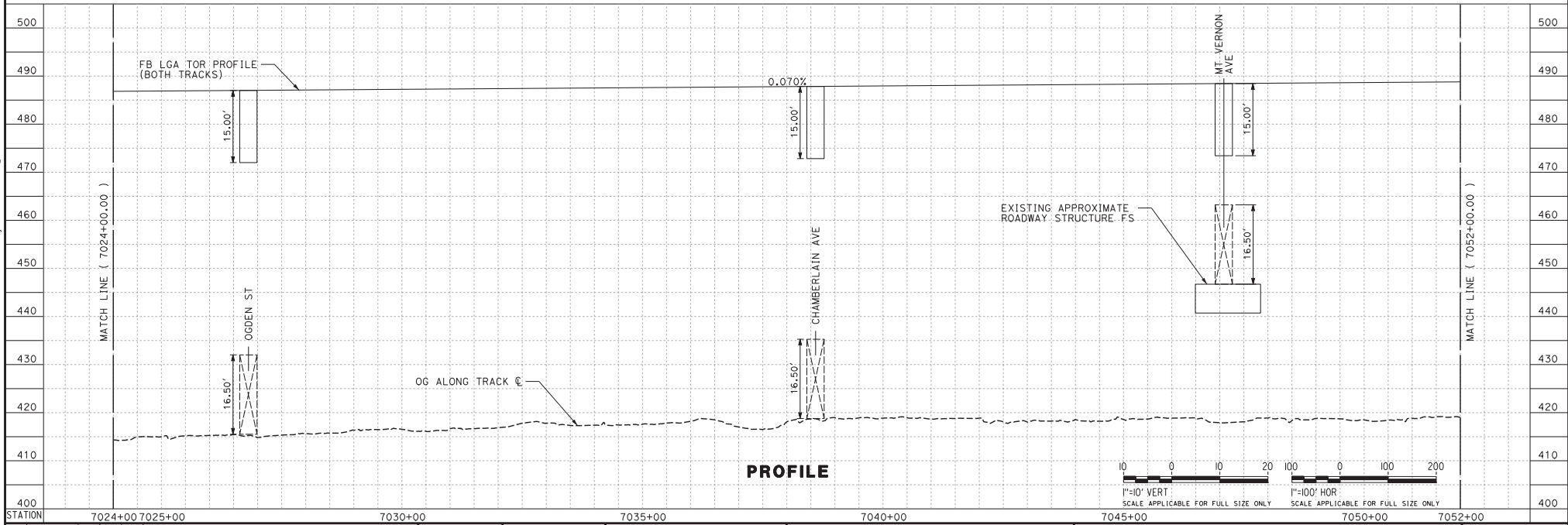

REV	DATE	BY	CHK	APP	DESCRIPTION

DESIGNED BY  
J. TREJO  
 DRAWN BY  
J. TREJO  
 CHECKED BY  
E. WINTERS  
 IN CHARGE  
P. PIENTON  
 DATE  
10/28/2016

**RECORD SET  
 PEDD DESIGN  
 SUBMISSION**



**CALIFORNIA HIGH-SPEED RAIL PROJECT**  
**FRESNO TO BAKERSFIELD**  
 LOCALLY GENERATED ALTERNATIVE  
 TRACK GUIDEWAY  
 STA 7024+00 TO 7052+00  
 PROPOSED SOUND BARRIER

CONTRACT NO.  
HSR13-44  
 DRAWING NO.  
TT-D1045  
 SCALE  
AS SHOWN  
 SHEET NO.

Projects\701206.N.BF55.00\_CADD\Sheet Files\Sound Barriers\BF55A-TT-D1046.dgn  
 #PENTBLS#  
 #PLTDRVS#  
 12/21/2016 10:00:36 PM  
 JTL\JTrejo

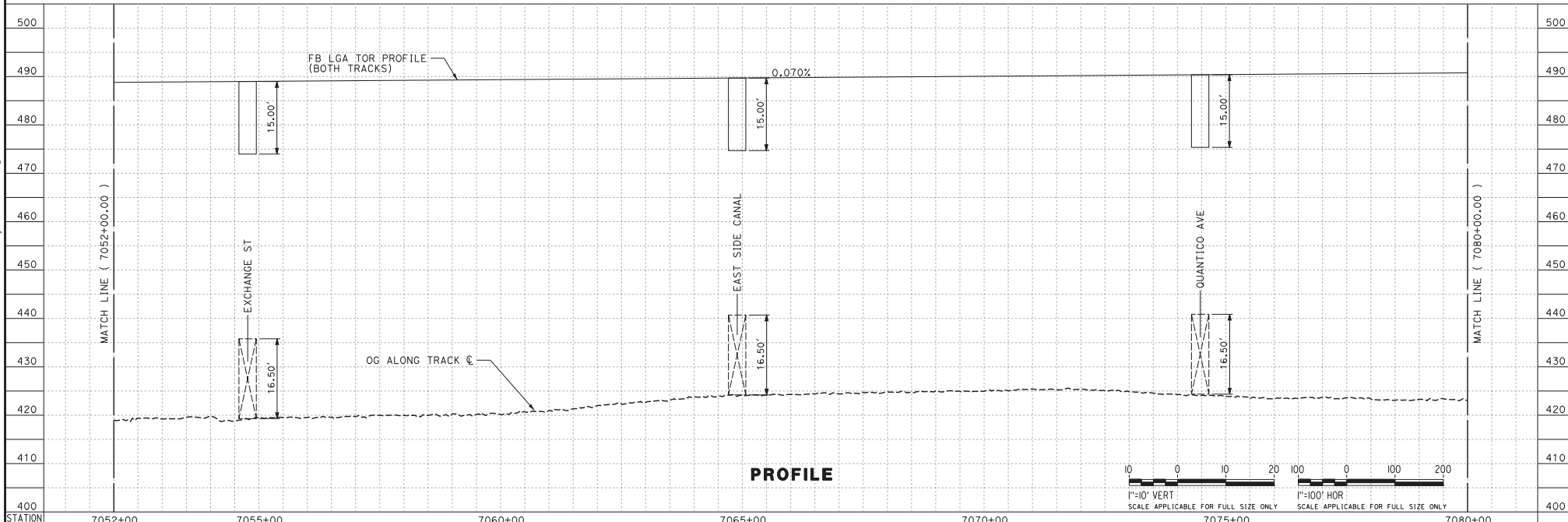
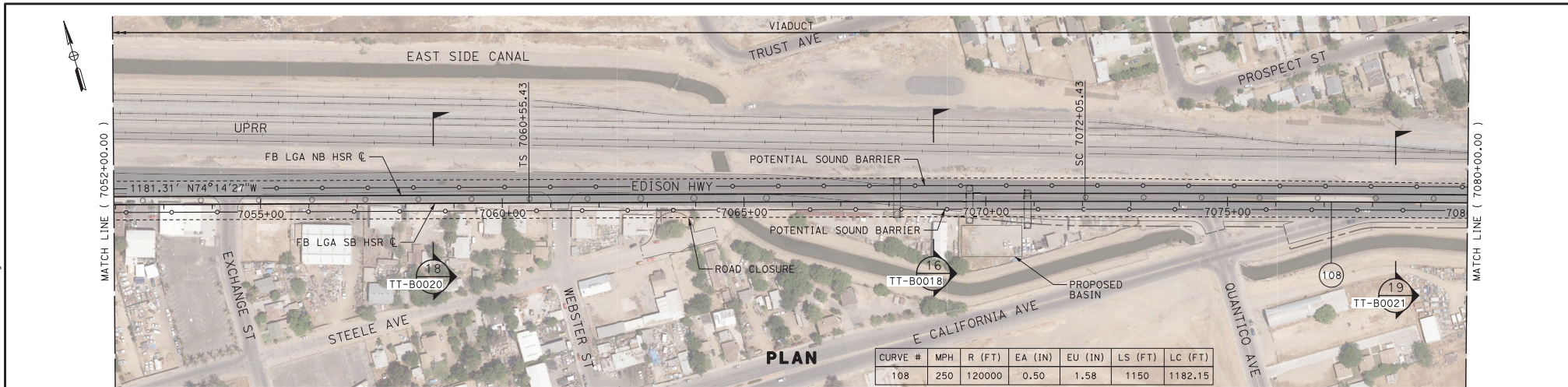

REV	DATE	BY	CHK	APP	DESCRIPTION

DESIGNED BY  
**J. TREJO**  
 DRAWN BY  
**J. TREJO**  
 CHECKED BY  
**E. WINTERS**  
 IN CHARGE  
**P. PIENTON**  
 DATE  
**10/28/2016**

**RECORD SET**  
**PEPD DESIGN**  
**SUBMISSION**  
**TYLIN INTERNATIONAL**



**CALIFORNIA HIGH-SPEED RAIL PROJECT**  
**FRESNO TO BAKERSFIELD**  
 LOCALLY GENERATED ALTERNATIVE  
 TRACK GUIDEWAY  
 STA 7052+00 TO 7080+00  
 PROPOSED SOUND BARRIER

CONTRACT NO.  
**HSR13-44**  
 DRAWING NO.  
**TT-D1046**  
 SCALE  
**AS SHOWN**  
 SHEET NO.

Projects\701206.N.BF55.00.CADD\Sheet Files\Sound Barriers\BF55A-TT-D1047.dgn  
 #PENTBL5#  
 #PLTDRV5#  
 12/21/2016 2:59:49 PM

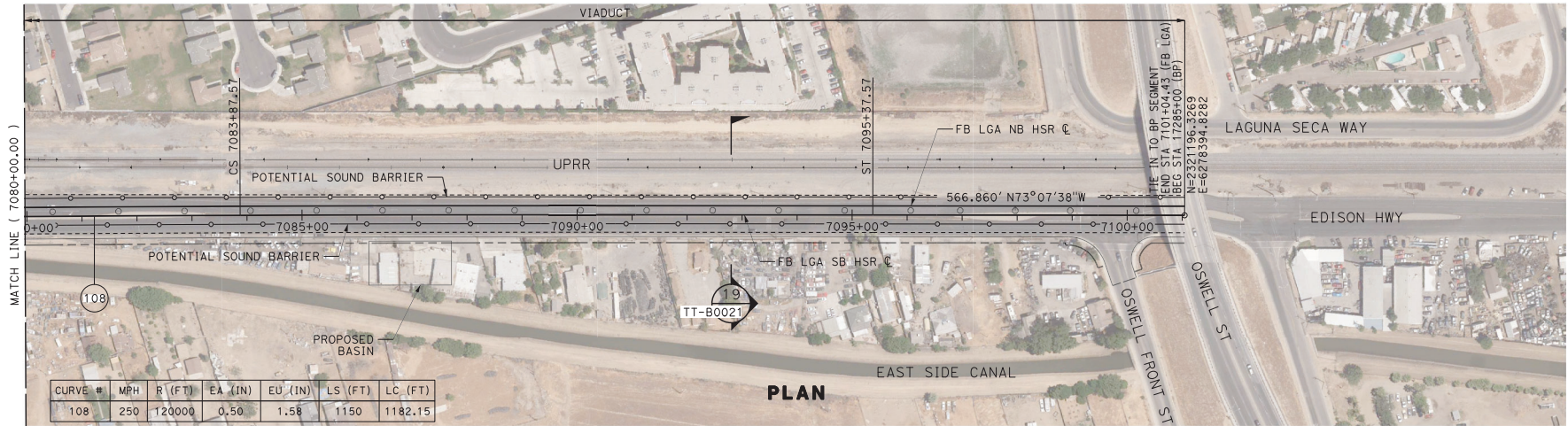

**PLAN**

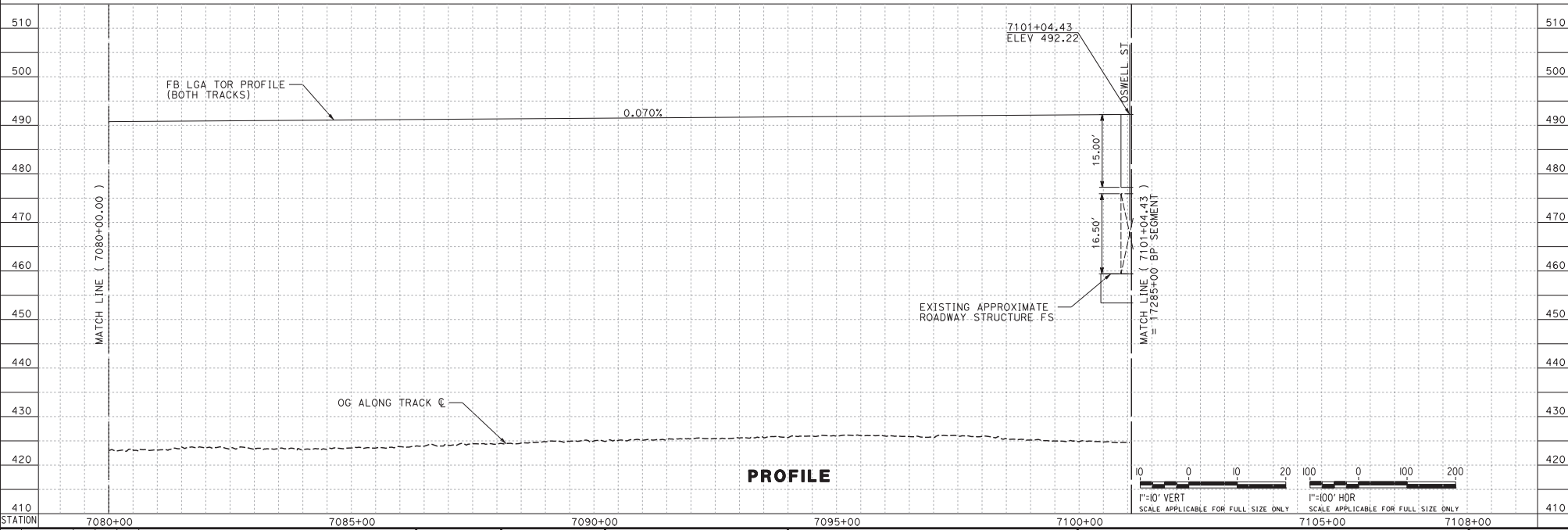

**PROFILE**

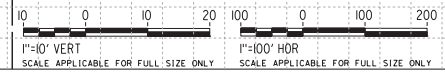

REV	DATE	BY	CHK	APP	DESCRIPTION

DESIGNED BY  
J. TREJO  
 DRAWN BY  
J. TREJO  
 CHECKED BY  
E. WINTERS  
 IN CHARGE  
P. PIENTON  
 DATE  
10/28/2016

**RECORD SET  
 PEDD DESIGN  
 SUBMISSION**



**CALIFORNIA HIGH-SPEED RAIL PROJECT  
 FRESNO TO BAKERSFIELD**  
 LOCALLY GENERATED ALTERNATIVE  
 TRACK GUIDEWAY  
 STA 7080+00 TO 7101+04  
 PROPOSED SOUND BARRIER

CONTRACT NO.  
HSR13-44  
 DRAWING NO.  
TT-D1047  
 SCALE  
AS SHOWN  
 SHEET NO.